

PROJECT	DESIGNATION
	1173162
CONTRACT	
R35622	

CITY OF FORT WAYNE, INDIANA

ROAD PLANS

MAPLECREST ROAD ADDED TRAVEL LANES - PROJECT NO. 1173162

Project Description: Road Rehabilitation on Maplecrest Road, from E. State Blvd. to Stellhorn Rd., located in Sections 21, 22, 27, 28, 33 & 34, T-31-N, R-13-E, St. Joseph Township, Allen County, Indiana.

Gross Length: 1.286 MILES
 Net Length: 1.286 MILES
 Maximum Grade: 1.60%

TRAFFIC DATA (Maplecrest Rd.)	
A.A.D.T. (2017)	21,170 V.P.D.
A.A.D.T. (2037)	28,520 V.P.D.
D.H.V. (2037)	2,852 V.P.H.
DIRECTIONAL DISTRIBUTION	50%
TRUCKS	3.7% A.A.D.T. 3.7% D.H.V.
DESIGN DATA	
DESIGN SPEED	35 M.P.H.
PROJECT DESIGN CRITERIA	RECONSTRUCTION (NON-FREEWAY)
FUNCTIONAL CLASSIFICATION	MINOR ARTERIAL
RURAL/URBAN	URBAN (INTERMEDIATE)
TERRAIN	LEVEL
ACCESS CONTROL	NONE

TRAFFIC DATA (Stellhorn Rd.)	
A.A.D.T. (2017)	19,630 V.P.D.
A.A.D.T. (2037)	26,430 V.P.D.
D.H.V. (2037)	2,643 V.P.H.
DIRECTIONAL DISTRIBUTION	50%
TRUCKS	1% A.A.D.T. 1% D.H.V.
DESIGN DATA	
DESIGN SPEED	45 M.P.H.
PROJECT DESIGN CRITERIA	3R (NON-FREEWAY)
FUNCTIONAL CLASSIFICATION	MINOR ARTERIAL
RURAL/URBAN	URBAN (INTERMEDIATE)
TERRAIN	LEVEL
ACCESS CONTROL	NONE

MAYOR

HONORABLE THOMAS C. HENRY

BOARD OF PUBLIC WORKS

ROBERT P. KENNEDY, CHAIRMAN

KUMAR MENON, MEMBER

MIKE AVILA, MEMBER

ATTEST:

LINDSEY RICHARDS, CLERK

EMPLOYEE IN RESPONSIBLE CHARGE (ERC):

NISHANTHA GUNAWARDENA, PE, PTOE, CITY ENGINEER

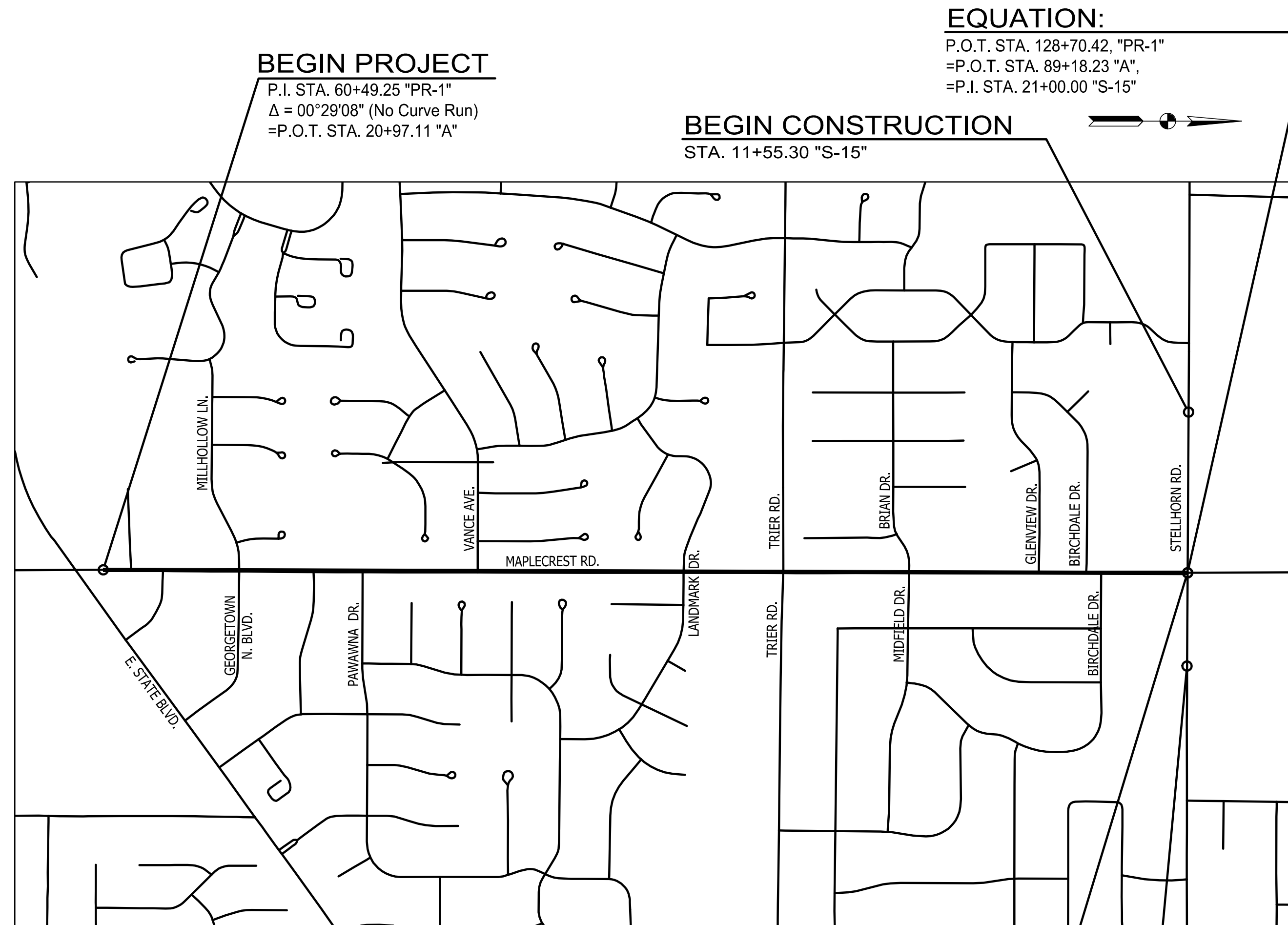

Scale: N.T.S.
LOCATION MAP
 SEC. 21, 22, 27, 28, 33, 34, T 31 N, R 13 E
 ST. JOSEPH TOWNSHIP
 ALLEN COUNTY, INDIANA

H.U.C. #04100005010040
 #04100005010010
 LATITUDE: N 41° 06' 48"
 LONGITUDE: W 85° 03' 40"

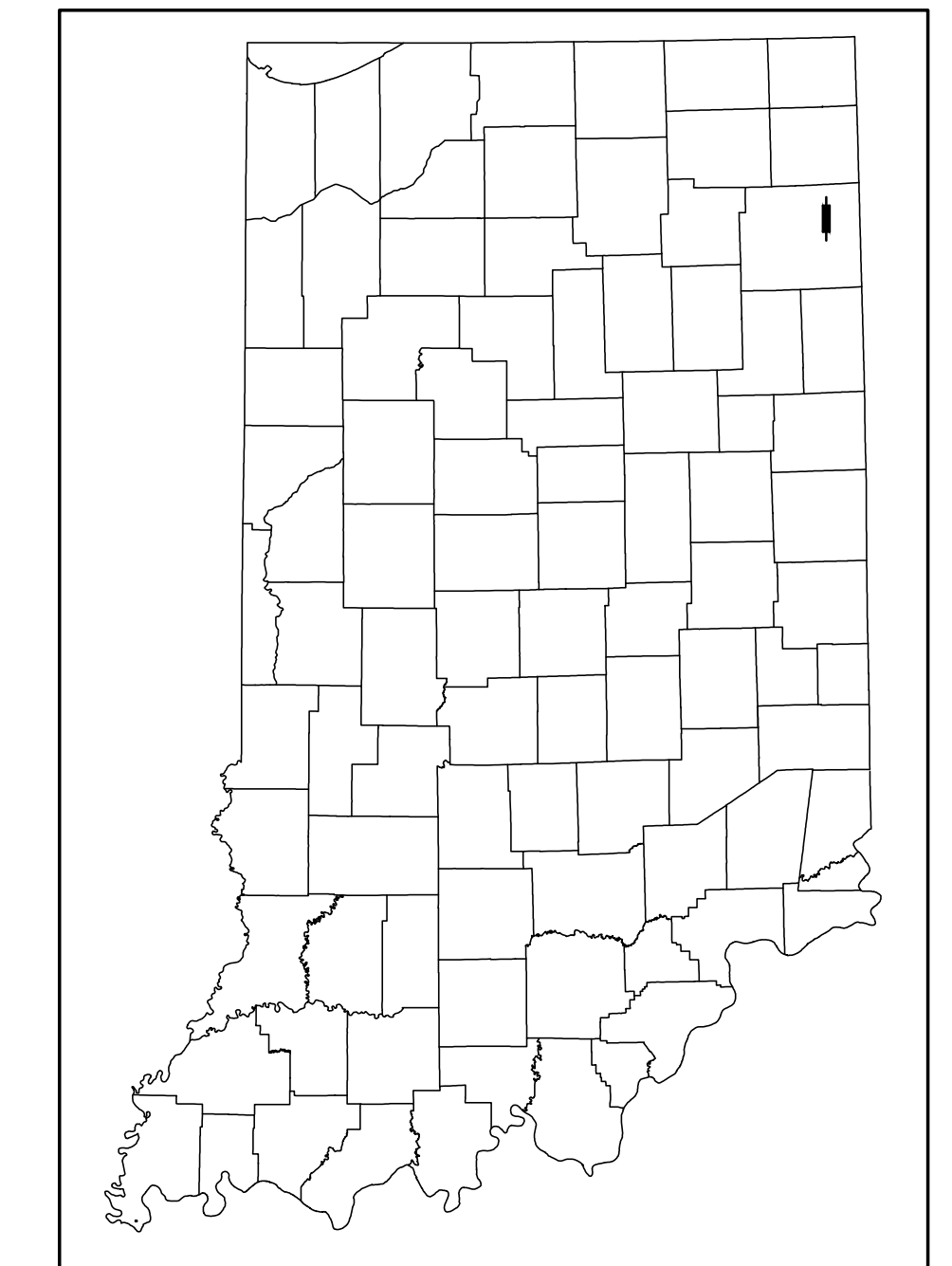

PROJECT LOCATION SHOWN BY

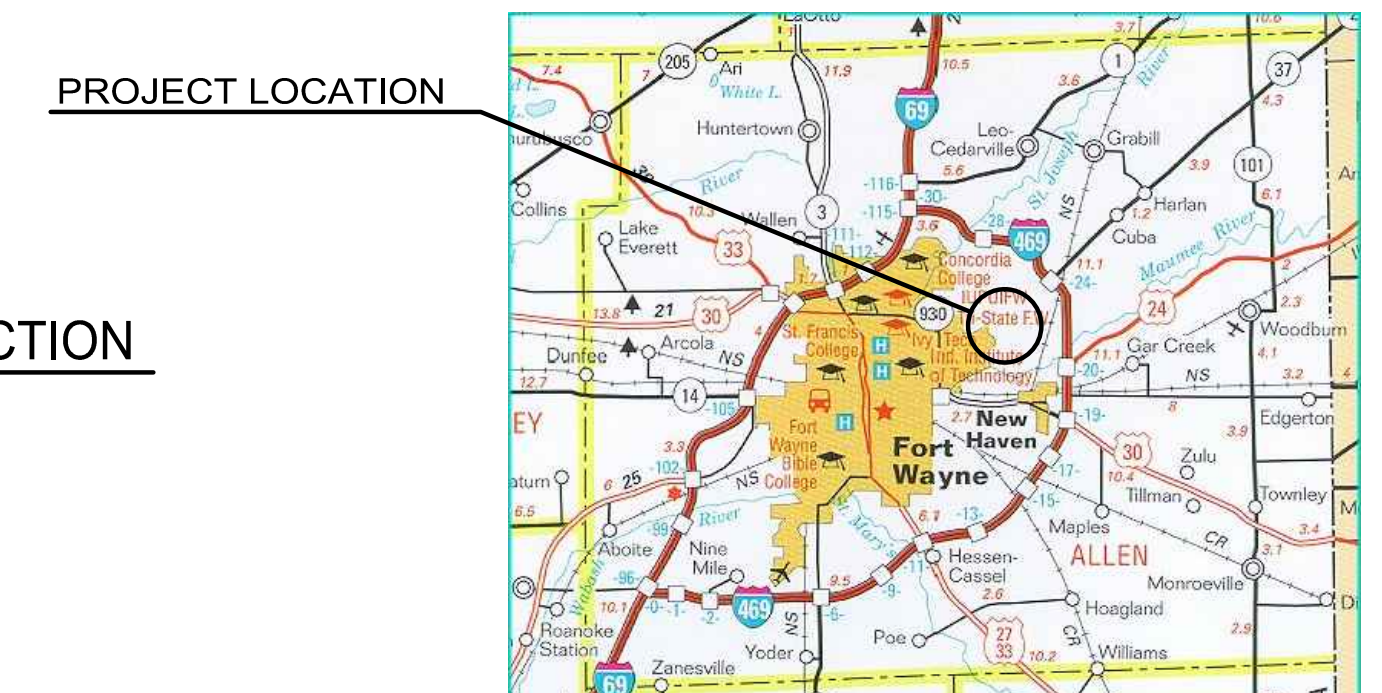

COUNTY LOCATION MAP
 Scale: N.T.S.

INDIANA DEPARTMENT OF TRANSPORTATION
 STANDARD SPECIFICATIONS DATED 2016
 TO BE USED WITH THESE PLANS

A&Z ENGINEERING
 9017 Coldwater Road, Suite 500
 Fort Wayne, IN 46825
 260.485.7077
 www.az-engineering.net

PLANS PREPARED BY: A & Z Engineering, LLC
 PHONE NUMBER: 260.485.7077
 CERTIFIED BY: [Signature]
 DATE: [Blank]
 APPROVED FOR LENDING: [Signature]
 DATE: [Blank]

PRELIMINARY USE ONLY
NOT FOR CONSTRUCTION

INDIANA DEPARTMENT OF TRANSPORTATION

CITY OF FORT WAYNE
 MAPLECREST ROAD IMPROVEMENTS

TITLE SHEET

HORIZONTAL SCALE	N/A
VERTICAL SCALE	N/A
DESIGNATION	1173162
CONTRACT	R35622
SHEETS	1 of 1
PROJECT	1173162

S:\2013 Projects\13-359 Fort Wayne - Maplecrest Road State to Stellhorn CAD\Title Sht.dwg ---- 10/27/2016 9:43 AM ---- AZuser

MAPLECREST ROAD ADDED TRAVEL LANES - DES 1173162 - STAGE 2

UTILITIES & CONTACTS

CABLE TELEVISION

COMCAST CABLEVISION OF FORT WAYNE
720 TAYLOR STREET
FORT WAYNE, IN 46802
(260) 458-5179 OR (260) 410-3596 [DAVID HARRIS]

ELECTRIC (DISTRIBUTION)

INDIANA & MICHIGAN POWER
P.O. BOX 60, FLOOR 24
FORT WAYNE, IN 46801-0060
(260) 408-1895 [MARK WALLS]

FIBER OPTICS / TELECOMMUNICATIONS

ZAYO FIBER SOLUTIONS
1710 DIRECTORS ROW
FORT WAYNE, IN 46804
(260) 570-5677 [JASON GILPIN]

U.S. SIGNAL/RVP FIBER CO., LLC

7020 SOUTHBELT DRIVE, SE
CALEDONIA, MI 49316
(614) 483-6350 [RICK ANDRICKS]

GAS

NORTHERN INDIANA PUBLIC SERVICE CO (NIPSCO)
1501 HALE AVENUE
FORT WAYNE, IN 46802
(260) 439-1313 [PATRICK LOEFFLER]

TELEPHONE

FRONTIER COMMUNICATIONS
8001 W. JEFFERSON BLVD.
MAIL CODE: INFA01
FORT WAYNE, IN 46804
(260) 461-2268 [JUSTIN KOSCHER]

TRAFFIC SIGNAL & INTERCONNECT

CITY OF FORT WAYNE TRAFFIC OPERATIONS
CITIZENS SQUARE
200 EAST BERRY STREET
SUITE 210
FORT WAYNE, IN 46802
(260) 427-2343 [MARK DUHAIME]

SANITARY SEWER / STORM SEWER

CITY OF FORT WAYNE UTILITIES, ENGINEERING SUPPORT SERVICES
200 EAST BERRY STREET
SUITE 250
FORT WAYNE, IN 46802
(260) 427-5155 [DAN SMITH]

WATER

CITY OF FORT WAYNE CITY UTILITIES
CITIZENS SQUARE
200 EAST BERRY STREET
SUITE 140
FORT WAYNE, IN 46802
(260) 427-2475 OR (260) 740-6215 [BOB HINGA]

STREET LIGHTING

CITY OF FORT WAYNE STREET LIGHT OPERATIONS
CITIZENS SQUARE
200 EAST BERRY STREET
SUITE 210
FORT WAYNE, IN 46802
(260) 427-2787 [HERB BERG]



GENERAL NOTES

- All earth shoulders, median areas, and cut and fill slopes shall be plain or mulch seeded except where sodding or special nursery seeding is specified.
- The final cross sections of the grading contract will be the original cross sections of the paving contract. However, partial or complete cross sections shall be taken if necessary to determine the actual excavation quantities.
- Cohesionless soil should not be used within 1 ft. of the required finished surfaces of fill/cut slopes. They should be enclosed with a less erodible material.
- All trees shall be removed as shown on the plans or as directed by the project engineer. Trees shall be cut at or below ground surface to avoid leaving a snagging hazard. Then the stump shall be treated with a herbicide to prevent sprouting. No item of tree removal will be included in the itemized proposal.
- All exposed ground requiring mulched seeding on sloped greater than or equal to 3:1 shall receive erosion control blanket. All exposed swales or ditches which require seeding shall receive erosion control blanket.
- ** The plans show utility located within the project limits according to information obtained from various sources. The accuracy of the utility locations and plans in this respect is not guaranteed by A&Z Engineering.

** REPRESENTS GENERAL NOTES REQUIRED

INDEX

SHEET NO.	DESIGNATION
1	TITLE SHEET
2	INDEX AND GENERAL NOTES
3-6	TYPICAL CROSS SECTIONS
7-8	PLAT NO 1
9-24	MAINTENANCE OF TRAFFIC
25-43	PLAN & PROFILE SHEETS
44-59	CONSTRUCTION DETAIL
60-61	FILTRATION SWALE DETAIL
62-65	MISC. CONSTR. DETAILS
66	BOX CULVERT DETAIL
67-77	INTERSECTION DETAILS
78-80	TRAFFIC SIGNAL PLANS
81-86	PAVEMENT MARKINGS & SIGNAGE PLANS
87-89	LANDSCAPE PLANS
90-94	LIGHTING PLANS
95-96	APPROACH TABLE
97-105	STRUCTURE DATA TABLE
106-141	CROSS SECTIONS

SECTION CORNER REFERENCES

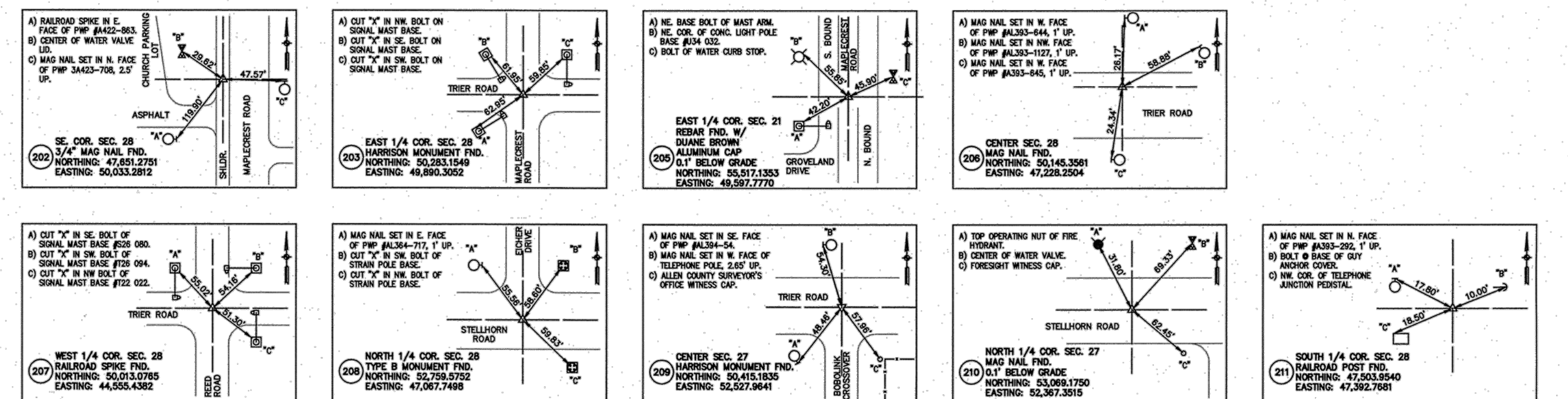

ALIGNMENT REFERENCES

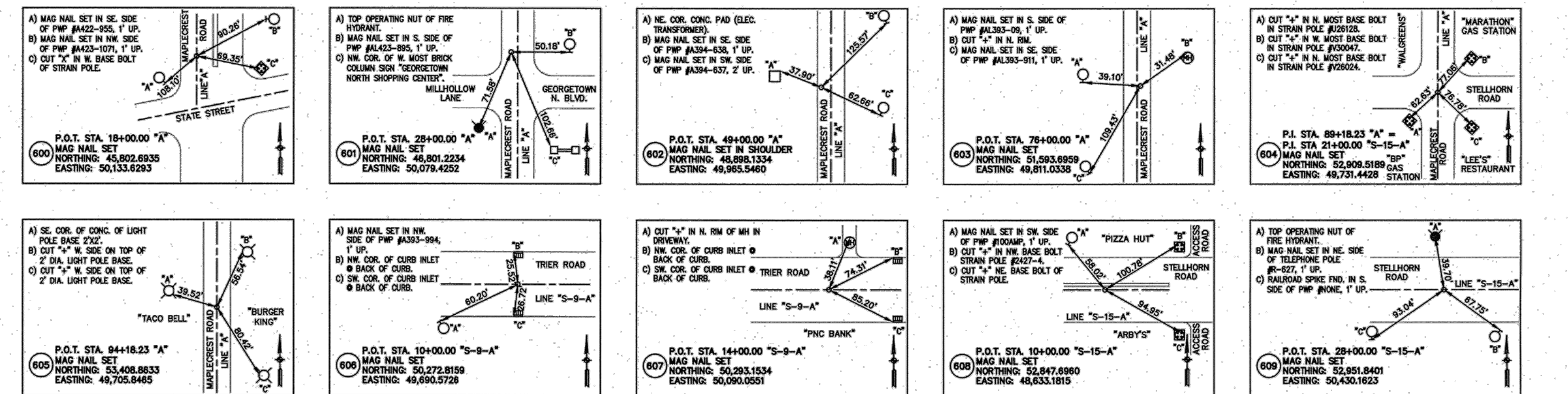

REVISIONS

SHEET NO.	DATE	REVISED

A&Z ENGINEERING
9017 Coldwater Road, Suite 500
Fort Wayne, IN 46825
260.485.7077
www.az-engineering.net

RECOMMENDED FOR APPROVAL
PRELIMINARY USE ONLY
NOT FOR CONSTRUCTION
DESIGN ENGINEER: C.H.
DRAWN: M.R.S.
CHECKED: W.J.Z. CHECKED: C.H.

CITY OF FORT WAYNE
MAPLECREST ROAD IMPROVEMENTS

INDEX AND GENERAL NOTES

HORIZONTAL SCALE	N/A
VERTICAL SCALE	N/A
DESIGNATION	1173162
CONTRACT	R35622
SHEETS	2 of
PROJECT NUMBER	1173162

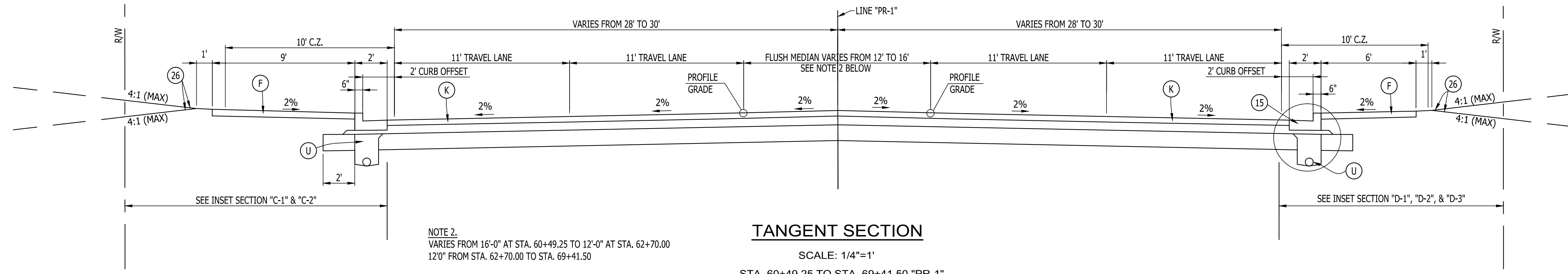

NOTE 2:
VARIES FROM 16'-0" AT STA. 60+49.25 TO 12'-0" AT STA. 62+70.00
12'-0" FROM STA. 62+70.00 TO STA. 69+41.50

TANGENT SECTION

SCALE: 1/4"=1'
STA. 60+49.25 TO STA. 69+41.50 "PR-1"
MAPLECREST RD.

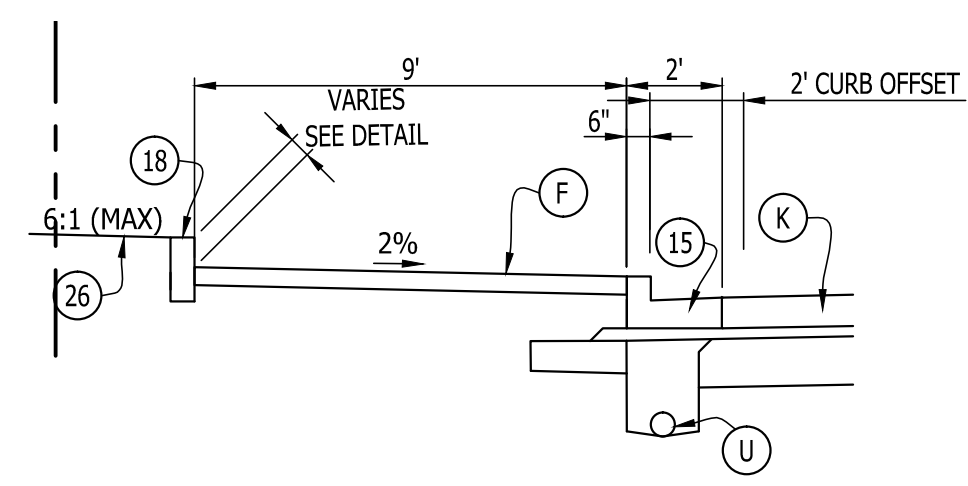

INSET SECTION "C-1"
STA. 65+55.00 TO STA. 66+65.00 "PR-1", LT

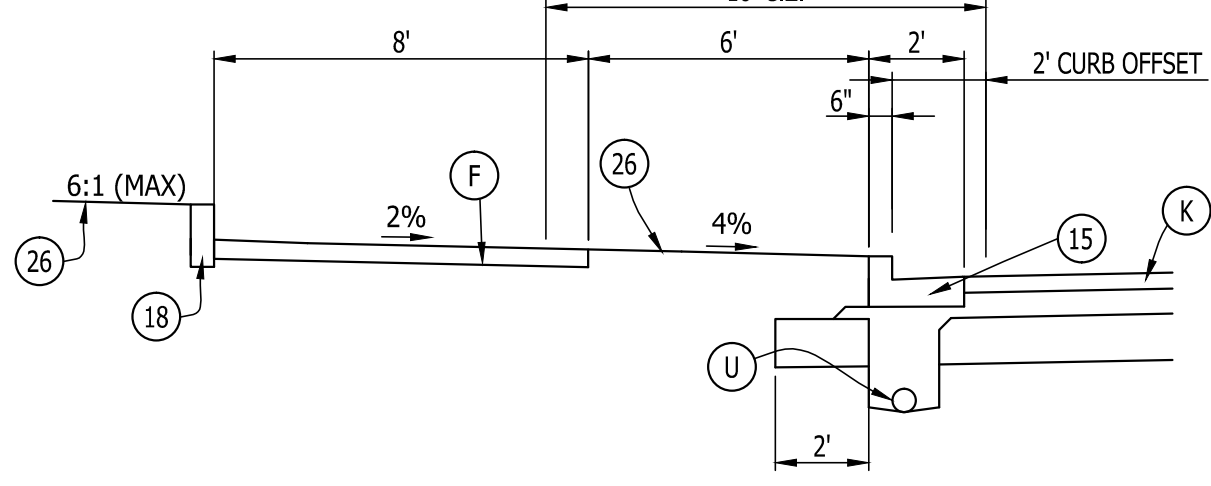

INSET SECTION "C-2"
STA. 67+29.00 TO STA. 69+41.50, LT., "PR-1"

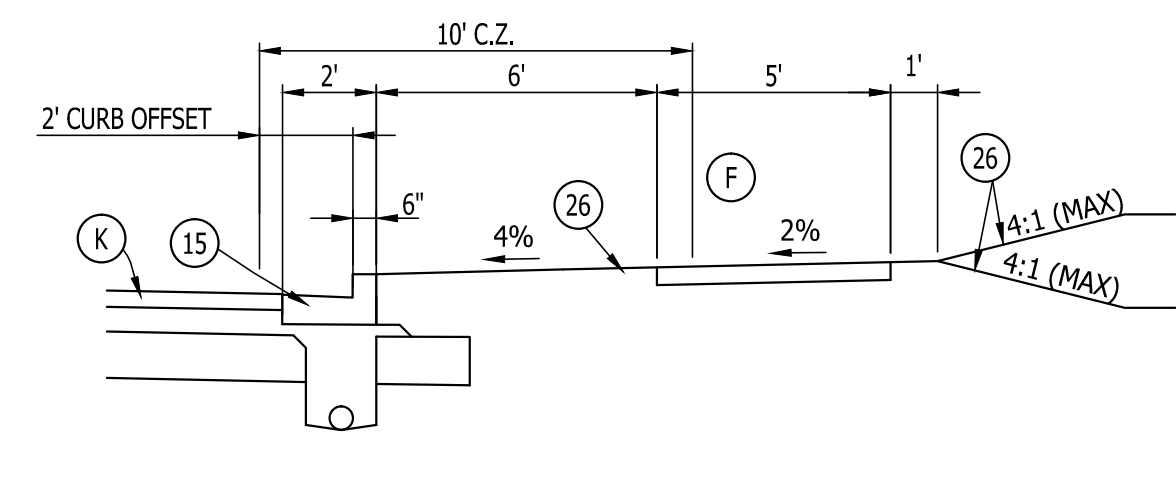

INSET SECTION "D-3"
STA. 67+29.00 TO STA. 69+41.50, RT., "PR-1"

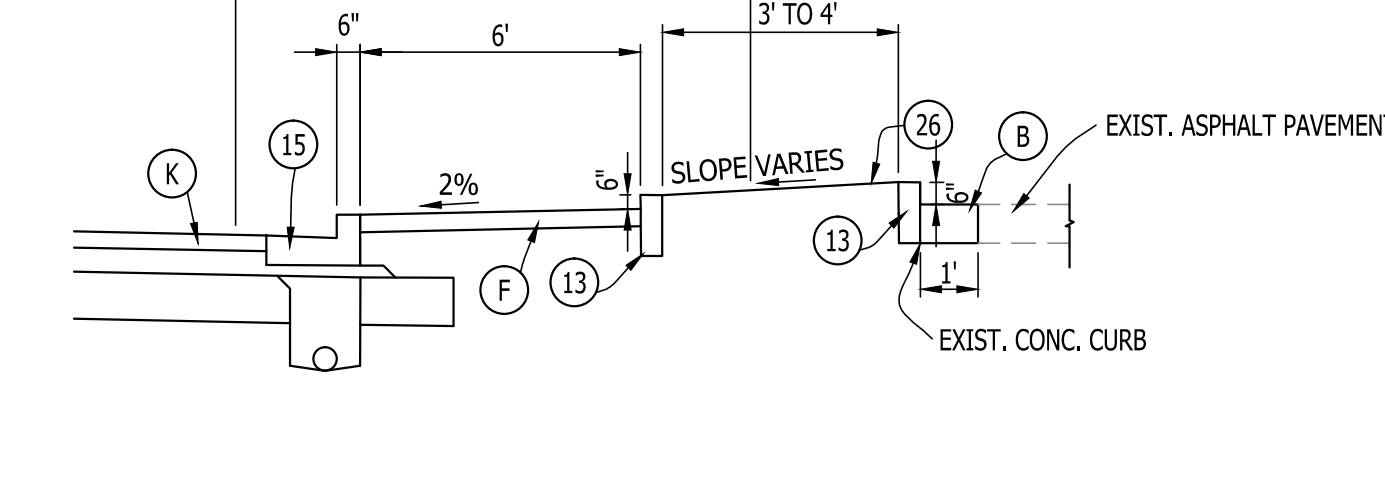

INSET SECTION "D-2"
STA. 60+49.25 TO STA. 61+65.00 "PR-1"
STA. 64+16.00 TO STA. 66+60.00 "PR-1"

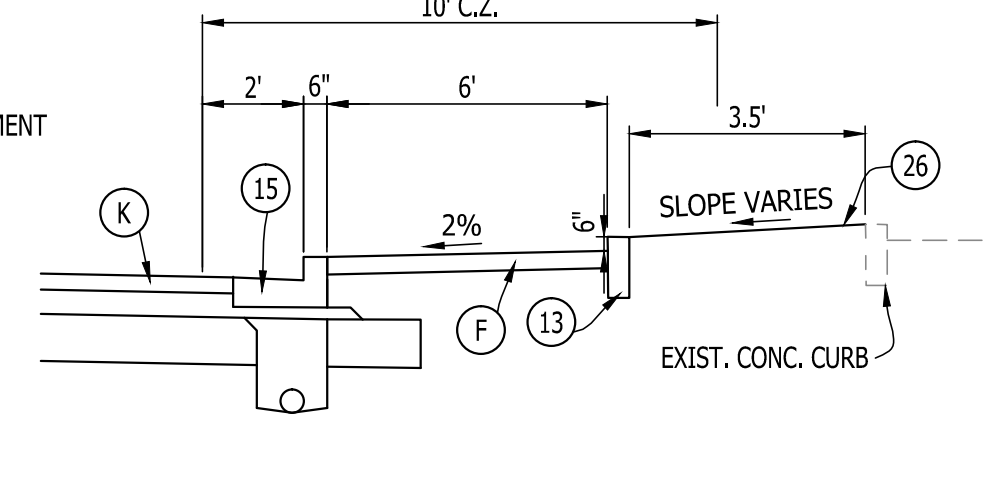

INSET SECTION "D-1"
STA. 58+20.00 TO STA. 60+24.00 "PR-1"

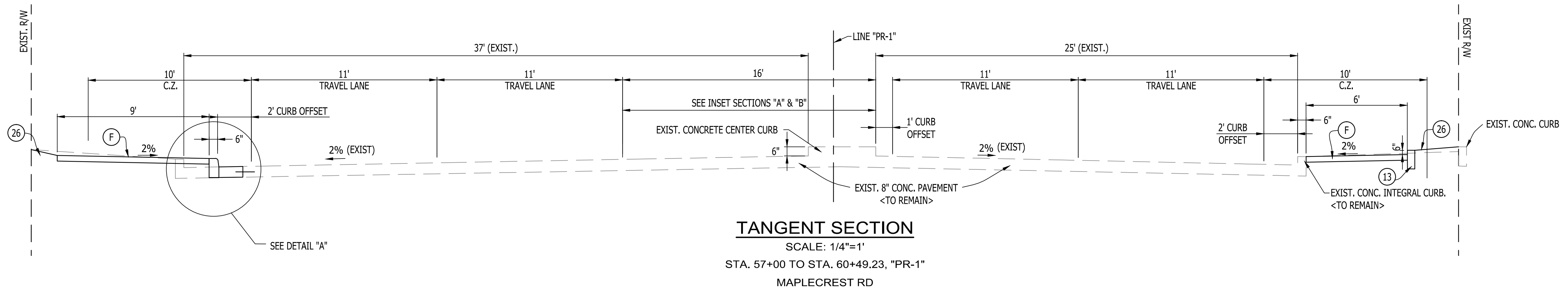

TANGENT SECTION

SCALE: 1/4"=1'
STA. 57+00 TO STA. 60+49.23, "PR-1"
MAPLECREST RD

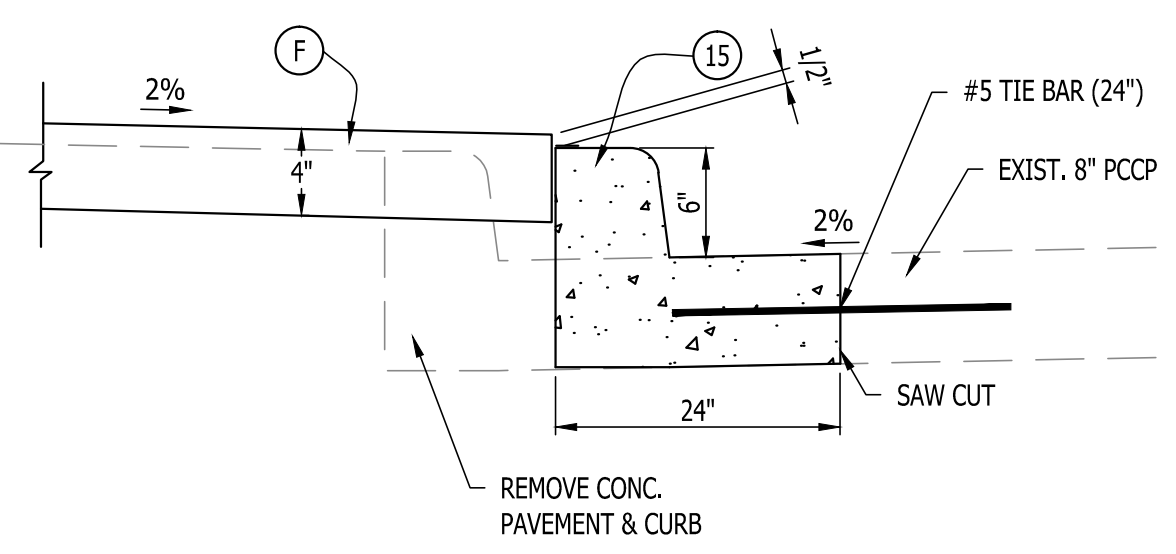

DETAIL "A"

NOTE 1:
REFER TO INDOT STANDARD E503-CCPJ-05 FOR
TIE-BAR SPECIFICATIONS

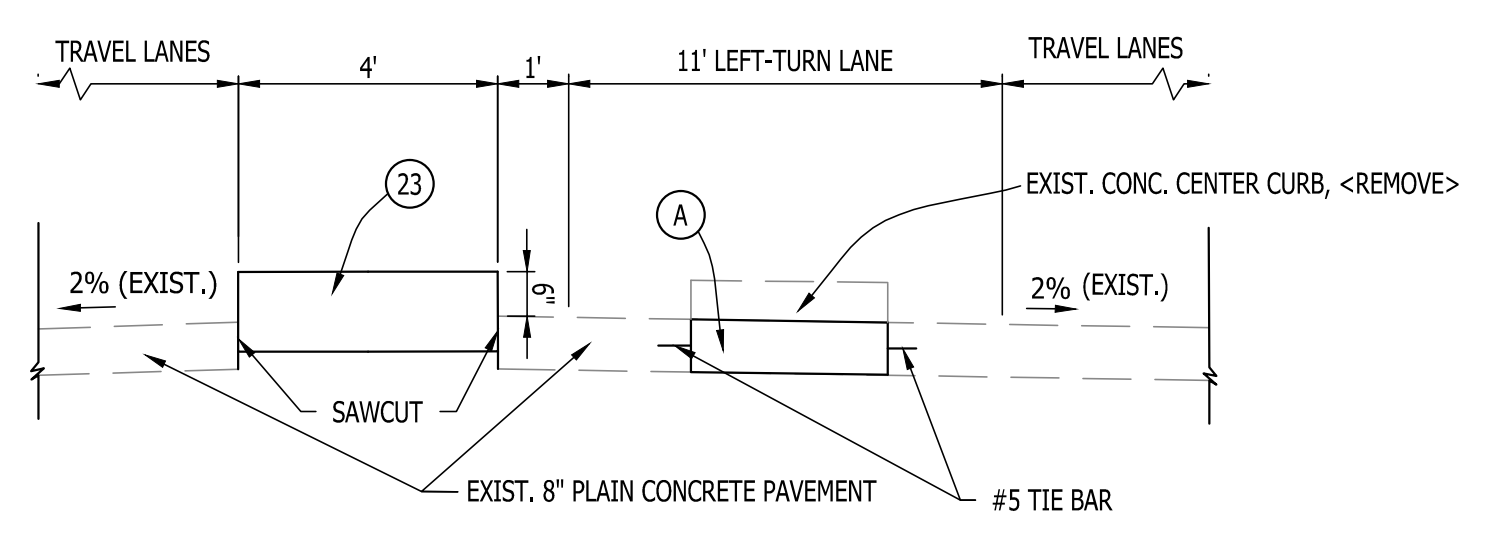

INSET SECTION "B"
NB LEFT-TURN LANE
STA. 58+61 TO STA. 59+76, "PR-1"

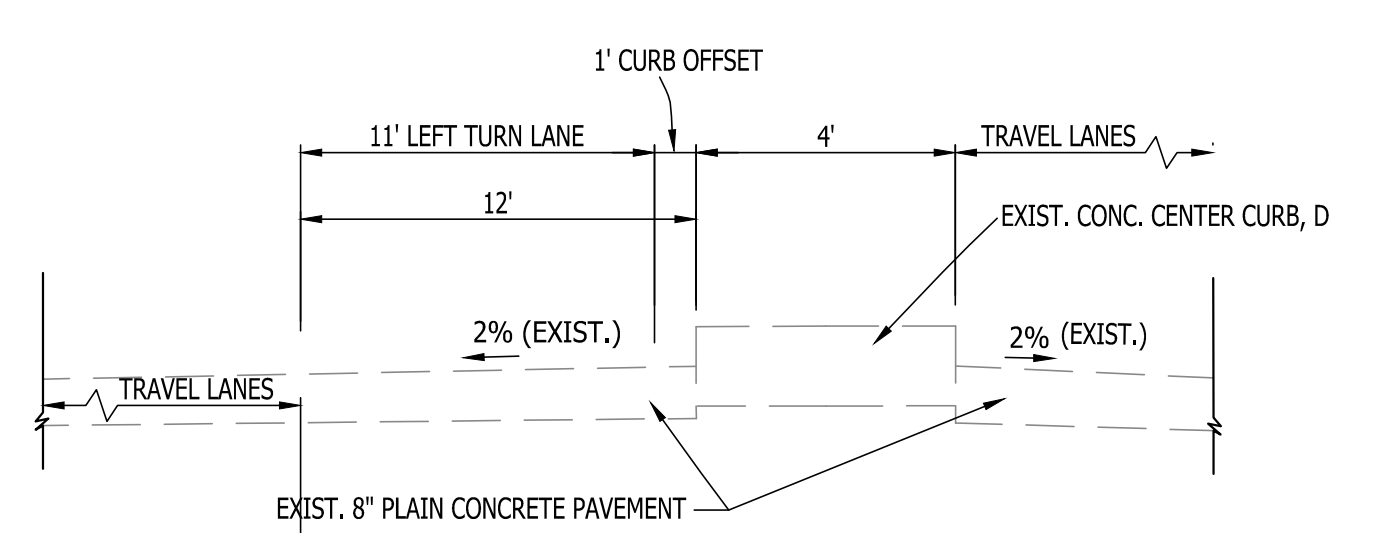

INSET SECTION "A"
SB LEFT-TURN LANE
STA. 57+00 TO STA. 59+31, "PR-1"

LEGEND

- (A) PCCP, PLAIN, 8" ON SUBBASE FOR PCCP
- (B) HMA FOR APPROACH, 165 #/SY QC/QA-HMA, 3, 76, SURFACE, 9.5 mm, ON 275 #/SY HMA INTERMEDIATE TYPE A ON SUBGRADE TREATMENT TYPE III
- (F) CONCRETE SIDEWALK
- (K) FULL DEPTH HMA PAVEMENT FOR MAINLINE 165 #/SY QC/QA-HMA, 3, 76, SURFACE 9.5 mm, ON 275 #/SY QC/QA-HMA, 3, 76, INTERMEDIATE 19.0 mm, ON XXX #/SY QC/QA-HMA, 3, 64, BASE 19.0 mm, ON XXX #/SY QC/QA-HMA, 5, 76, INTERMEDIATE, 19.0 mm, ON XXX #/SY QC/QA-HMA, 3, 64, BASE 19.0 mm, ON SUBGRADE TREATMENT TYPE III
- (R) HMA OVERLAY FOR MAINLINE 165 #/SY QC/QA-HMA, 3, 76, SURFACE, 9.5 mm, ON XXX #/SY QC/QA-HMA, 3, 76, INTERMEDIATE 19.0 mm, ON XXX ASPHALT SURFACE MILLING
- (U) UNDERDRAIN (SEE DETAIL)
- (13) CONCRETE CURB
- (15) CONCRETE CURB AND GUTTER, MODIFIED (SEE DETAIL)
- (18) MODULAR BLOCK RETAINING WALL (SEE DETAIL)
- (26) SODDING (NURSERY)
- C.Z.=CLEAR ZONE

A&Z ENGINEERING
9017 Coldwater Road, Suite 500
Fort Wayne, IN 46825
260.485.7077
www.az-engineering.net

PRELIMINARY USE ONLY
NOT FOR CONSTRUCTION

RECOMMENDED FOR APPROVAL
DESIGN ENGINEER: DATE
ASSIGNED: C.H. DRAWN: M.R.S.
CHECKED: W.J.Z. CHECKED: C.H.

CITY OF FORT WAYNE
MAPLECREST ROAD IMPROVEMENTS

TYPICAL CROSS SECTIONS

HORIZONTAL SCALE	AS SHOWN
VERTICAL SCALE	N/A
DESIGNATION	1173162
CONTRACT	R35622
SHEETS	3 of
PROJECT NUMBER	1173162

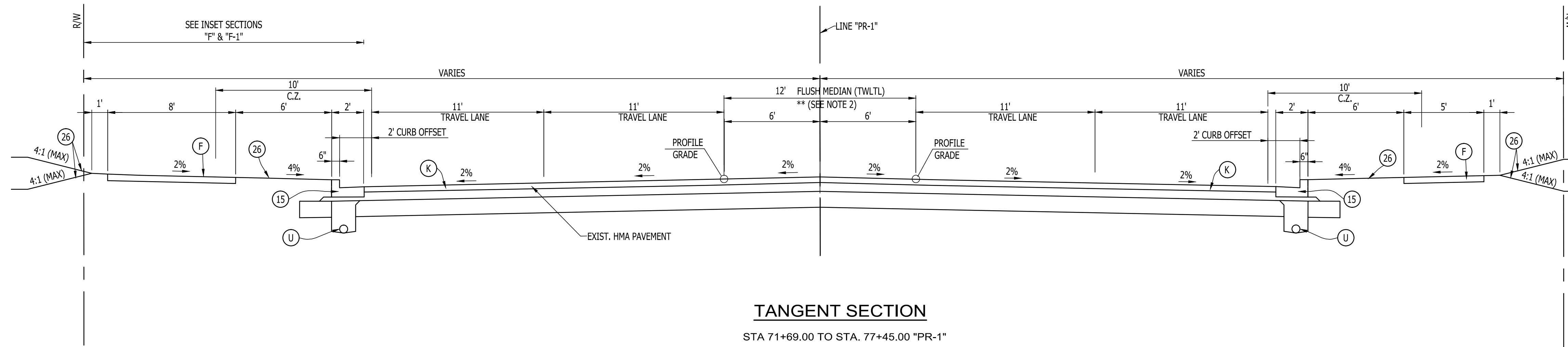

TANGENT SECTION

STA 71+69.00 TO STA. 77+45.00 "PR-1"
 STA. 80+15.00 TO STA. 82+90.00 "PR-1"
 STA. 93+75.00 TO STA. 99+62.50 "PR-1"
 STA. 104+75.00 TO STA. 126+55.00 "PR-1"
 MAPLECREST RD

NOTE 2:
 • Varies from 12'0" at Sta. 123+98.00 to 16'0" at Sta. 124+98.00 "PR-1"
 • Varies from 12'0" at Sta. 97+72.50 to 15'0" at Sta. 99+62.50 "PR-1"
 • Varies from 15'0" at Sta. 104+83.40 to 12'0" at Sta. 105+83.40 "PR-1"

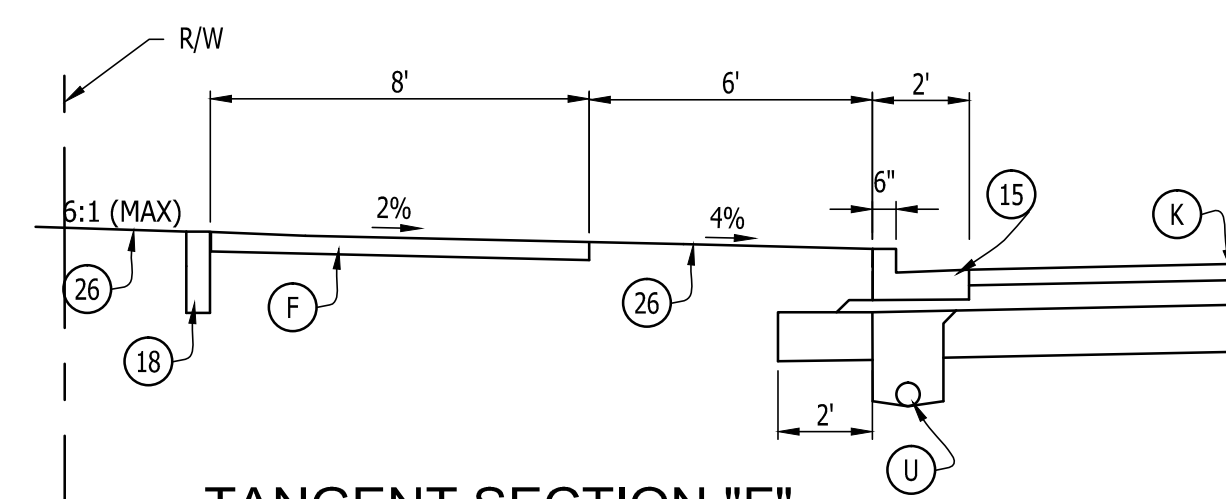

TANGENT SECTION "F"

STA 75+60.00 TO STA. 77+30.00 "PR-1", LT
 STA. 80+18.00 TO STA. 80+43.00 "PR-1", LT
 STA. 81+25.00 TO STA. 82+28.00 "PR-1", LT
 STA. 93+75.00 TO STA. 95+30.00 "PR-1", LT
 STA. 108+70.00 TO STA. 110+30.00 "PR-1", LT
 STA. 110+90.00 TO STA. 111+70.00 "PR-1", LT

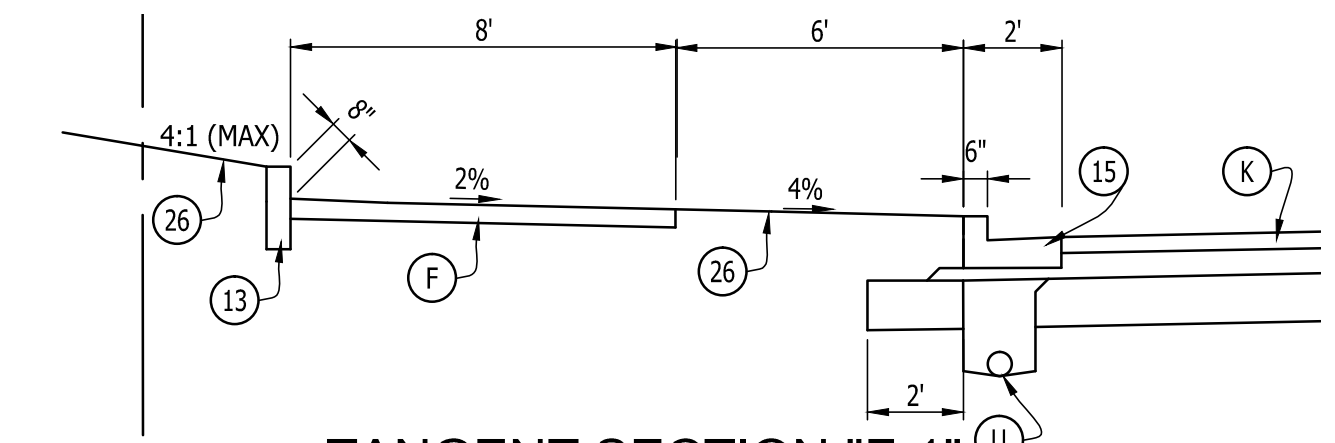

TANGENT SECTION "F-1"

STA 72+85.00 TO STA. 73+25.00 "PR-1", LT
 STA. 80+43.00 TO STA. 81+25.00 "PR-1", LT
 STA. 107+00.00 TO STA. 108+70.00 "PR-1", LT

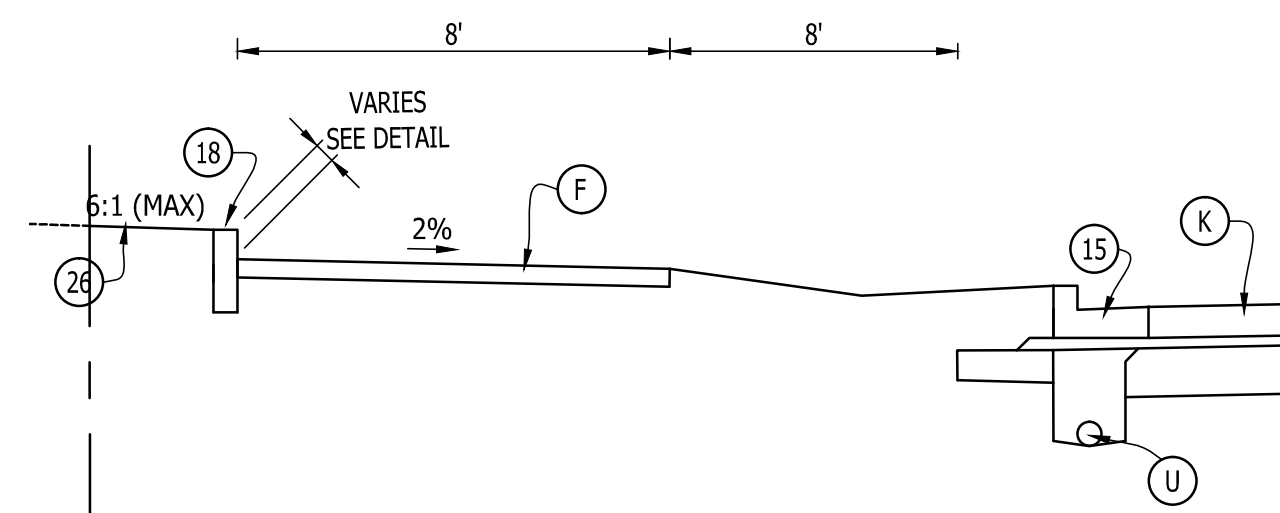

INSET SECTION "E-1"

STA. 69+75.00 TO STA. 70+30.00 "PR-1", LT
 STA. 77+67.00 TO STA. 80+18.00 "PR-1", LT
 STA. 91+85.00 TO STA. 93+75.00 "PR-1", LT

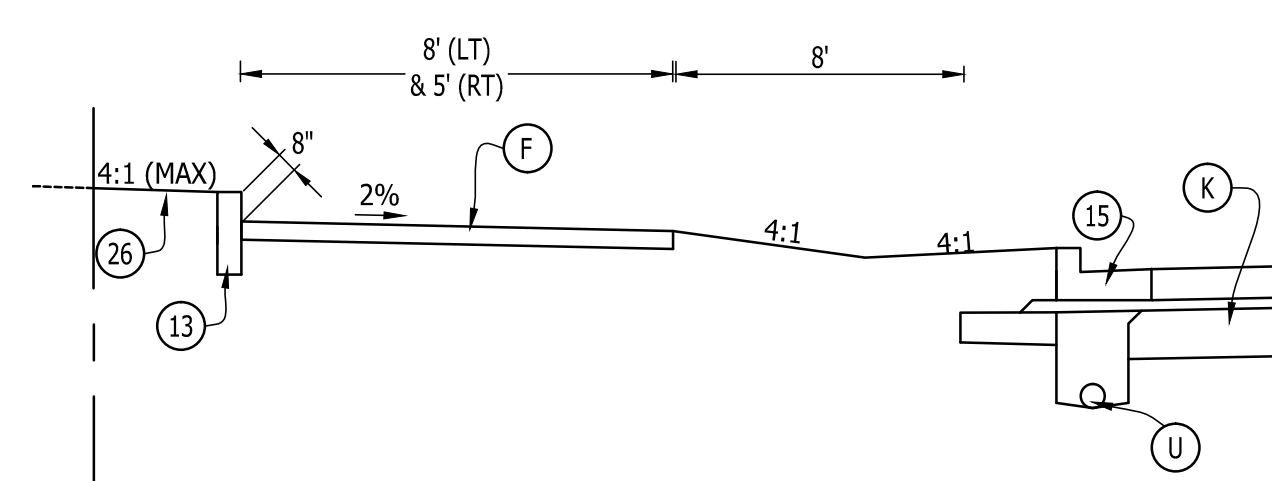

INSET SECTION "E-2"

STA. 82+93.00 TO STA. 85+25.00 "PR-1", LT
 STA. 85+75.00 TO STA. 86+75.00 "PR-1", RT
 <-REVERSE FIGURE FOR NORTHBOUND>

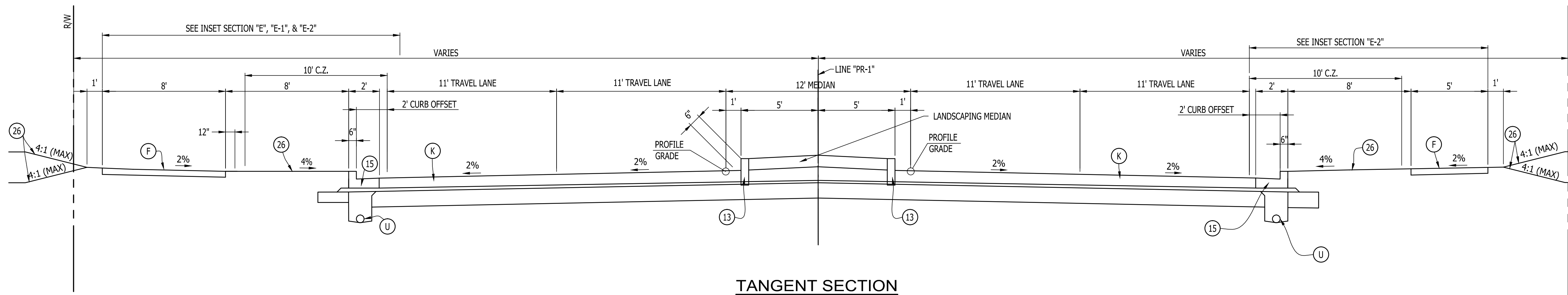

TANGENT SECTION

SCALE: 1/4"=1'
 STA. 69+41.50 TO STA. 71+69.00 "PR-1"
 STA. 77+45.00 TO STA. 80+18.00 "PR-1"
 STA. 82+90.00 TO STA. 93+75.00 "PR-1"

LEGEND

- (EC) EXISTING, CONC. CURB AND GUTTER (TO REMAIN)
 - (F) CONCRETE SIDEWALK
 - (K) FULL DEPTH HMA PAVEMENT FOR MAINLINE
 165 #/SY QC/QA-HMA, 3, 76, SURFACE 9.5 mm, ON
 275 #/SY QC/QA-HMA, 3, 76, INTERMEDIATE 19.0 mm, ON
 XXX #/SY QC/QA-HMA, 3, 64, BASE 19.0 mm, ON
 XXX #/SY QC/QA-HMA, 5, 76, INTERMEDIATE, 19.0 mm, ON
 XXX #/SY QC/QA-HMA, 3, 64, BASE 19.0 mm, ON
 SUBGRADE TREATMENT TYPE _
 - (R) HMA OVERLAY FOR MAINLINE
 165 #/SY QC/QA-HMA, 3, 76, SURFACE, 9.5 mm, ON
 XXX #/SY QC/QA-HMA, 3, 76, INTERMEDIATE 19.0 mm, ON
 XXX ASPHALT SURFACE MILLING
 - (U) UNDERDRAIN (SEE DETAIL)
 - (13) CONCRETE CURB
 - (15) CONCRETE CURB AND GUTTER, MODIFIED (SEE DETAIL)
 - (18) MODULAR BLOCK RETAINING WALL (SEE DETAIL)
 - (23) CONCRETE CENTER CURB TYPE "D"
 - (26) SODDING (NURSERY)
- Q.F.Z= OBSTRUCTION FREE ZONE
 C.Z.= CLEAR ZONE

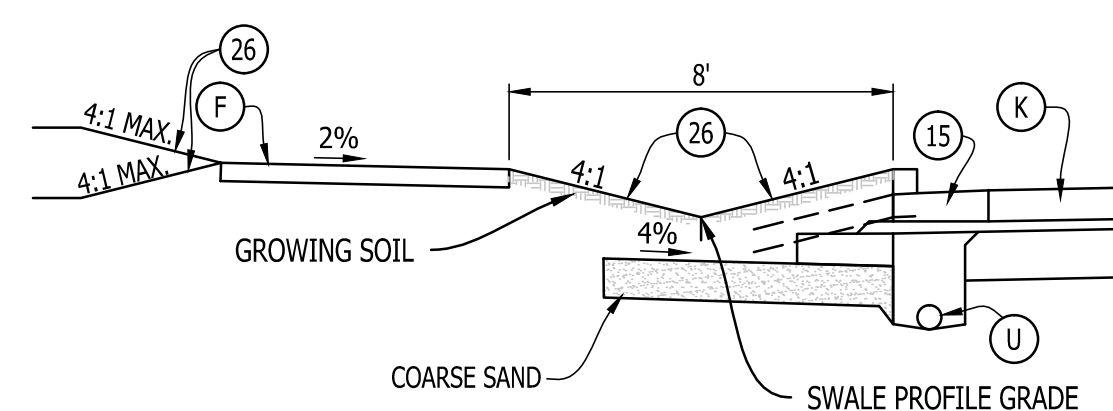

INSET SECTION "E"

INFILTRATION SWALE
 STA. 69+75.00 TO STA. 71+60.00 "PR-1", RT
 STA. 69+75.00 TO STA. 71+33.00 "PR-1", LT
 STA. 77+67.00 TO STA. 80+18.00 "PR-1", RT
 STA. 77+58.00 TO STA. 80+18.00 "PR-1", LT
 STA. 82+23.00 TO STA. 93+75.00 "PR-1", LT & RT
 (REVERSE FIGURE FOR NORTHBOUND)

NOTE 1:
 SEE INFILTRATION SWALE DETAILS AND LOCATIONS
 ON DETAIL SHEET NOS. 60 & 61

A&Z ENGINEERING
 9017 Coldwater Road, Suite 500
 Fort Wayne, IN 46825
 260.485.7077
 www.az-engineering.net

**PRELIMINARY USE ONLY
 NOT FOR CONSTRUCTION**

RECOMMENDED FOR APPROVAL
 DESIGN ENGINEER: [Signature]
 ASSIGNED: C.H.
 CHECKED: W.J.Z.

**CITY OF FORT WAYNE
 MAPLECREST ROAD IMPROVEMENTS**

TYPICAL CROSS SECTIONS

HORIZONTAL SCALE	AS SHOWN
VERTICAL SCALE	N/A
DESIGNATION	1173162
CONTRACT	R35622
SHEETS	4 of 4
PROJECT NUMBER	1173162

S:\2013 Projects\13-359 Fort Wayne - Maplecrest Road State to Steilhorn\CAD\13-359 TX.dwg --- 11/10/2015 2:06 PM --- AZuser

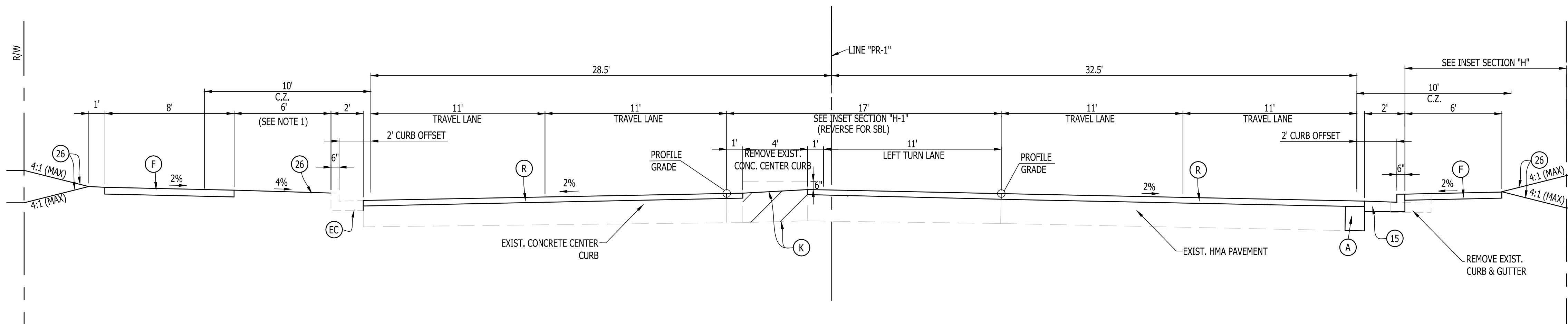

TANGENT SECTION

STA. 126+55.00 TO STA. 128+40.00 "PR-1"
MAPLECREST RD.

NOTE 1:
5' FROM STA. 127+40.00 TO STA. 128+26.00

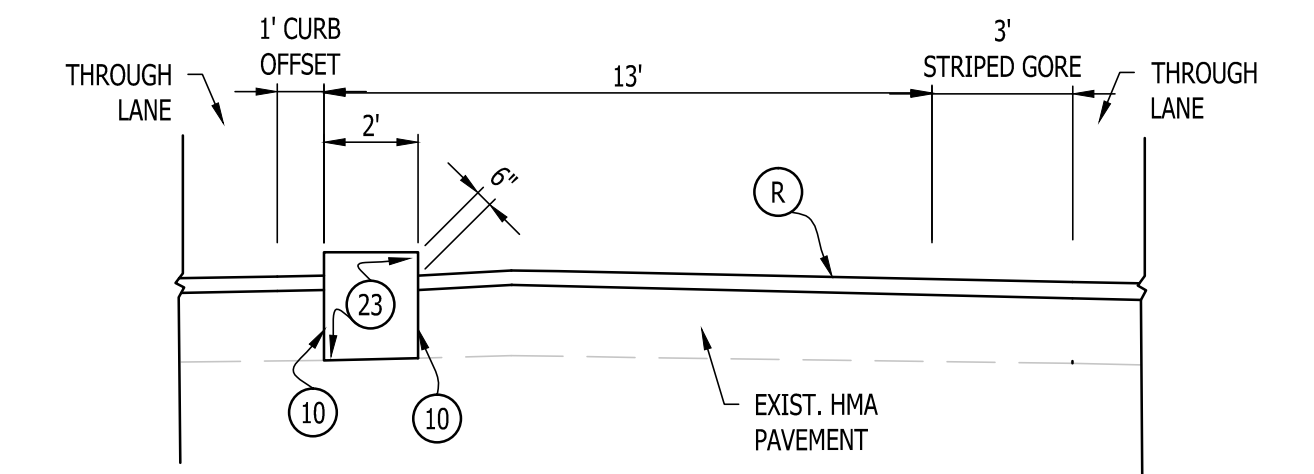
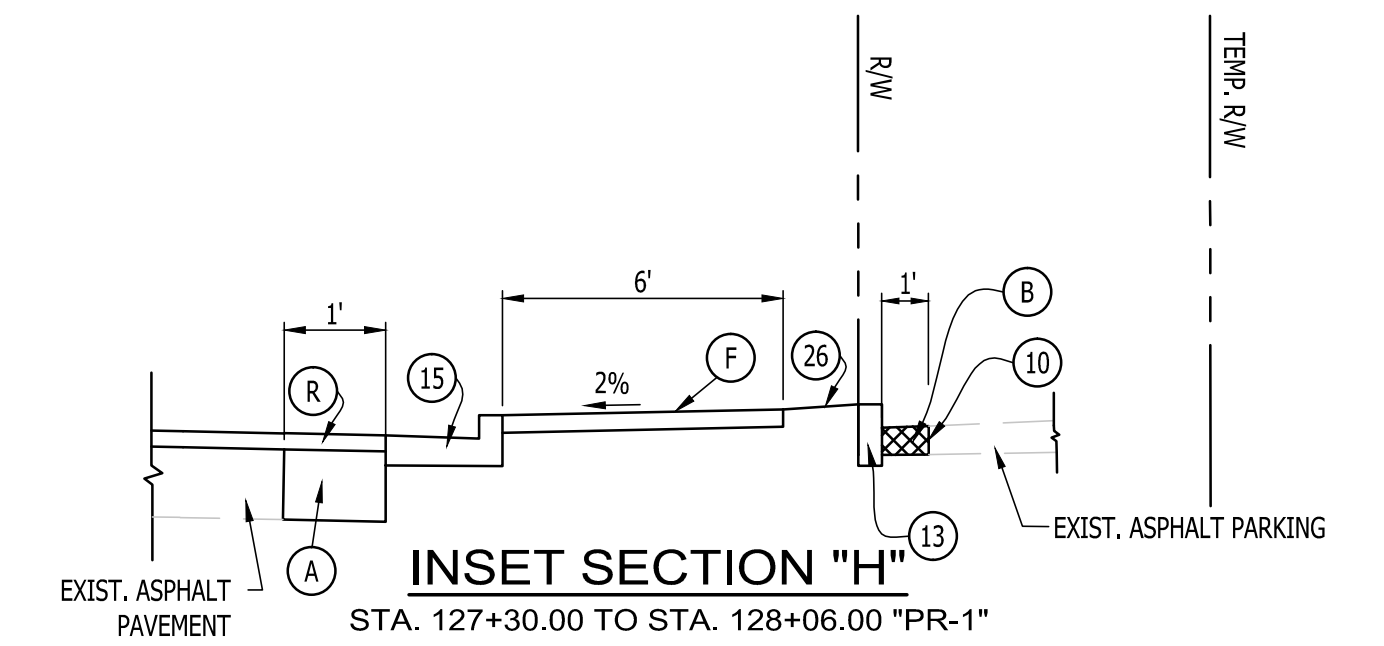

INSET SECTION "H-1"

STA. 126+60.00 TO STA. 128+11.00 "PR-1"

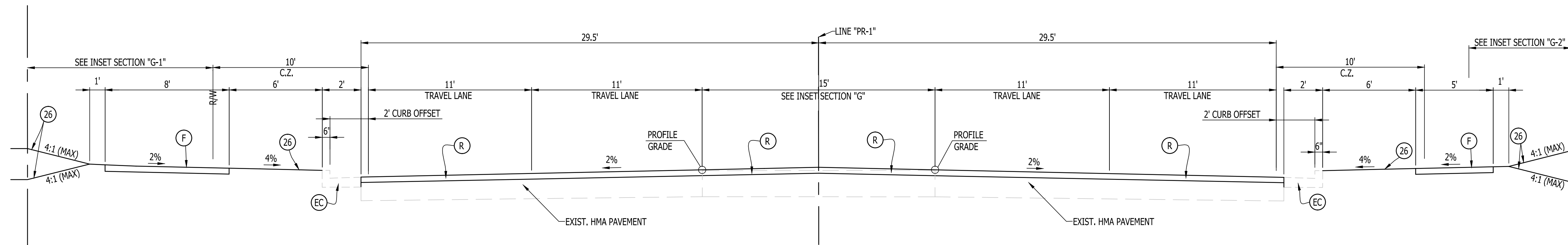

TANGENT SECTION

STA. 99+62.50 TO STA. 104+75.00 "PR-1"
MAPLECREST RD.

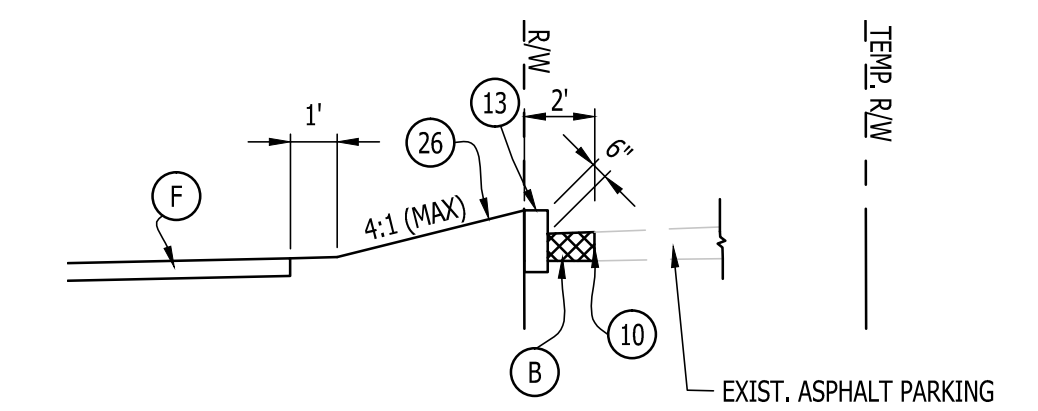

INSET SECTION "G-2"

STA. 99+40.00 TO STA. 101+64.00 "PR-1"

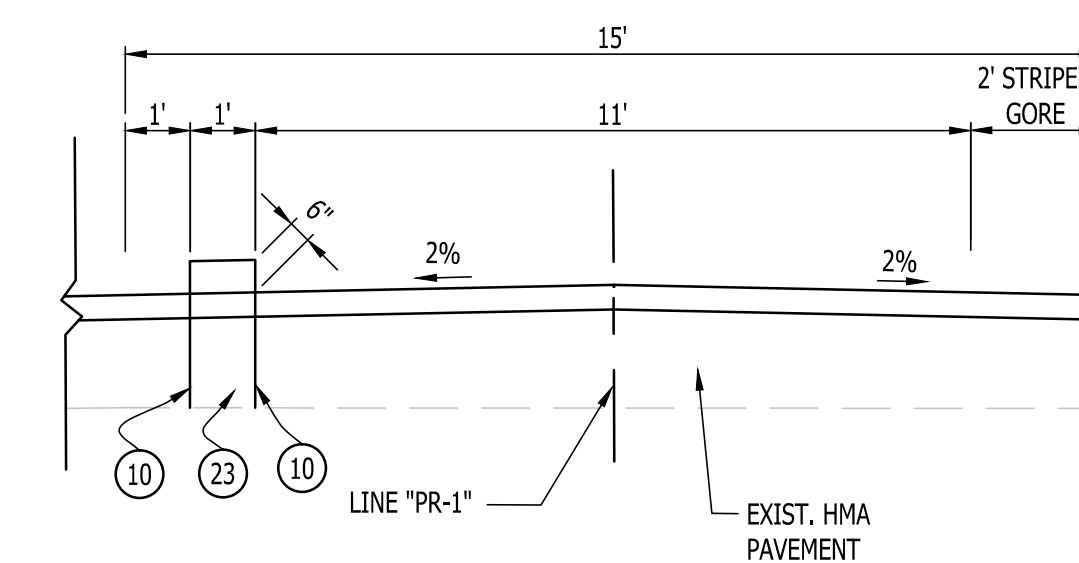

INSET SECTION "G"

(REVERSE FOR SOUTHBOUND)
STA. 100+17.00 TO STA. 104+75.00 "PR-1"

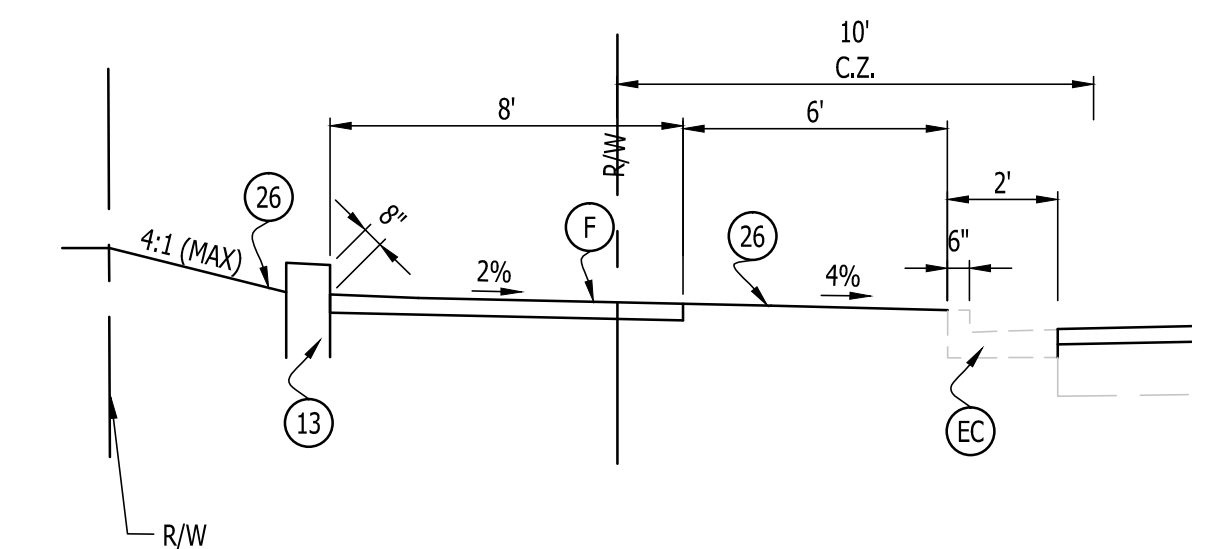

INSET SECTION "G-2"

STA. 103+04.00 TO STA. 104+50.00 "PR-1"

LEGEND

- (A) PCCP, PLAIN, 8" ON SUBBASE FOR PCCP
- (B) HMA FOR APPROACH, 165 #/SY QC/QA-HMA, 3, 76, SURFACE 9.5 mm, ON 275 #/SY QC/QA-HMA, 3, 76, INTERMEDIATE 19.0 mm, ON SUBGRADE TREATMENT TYPE III
- (EC) EXISTING, CONC. CURB AND GUTTER (TO REMAIN)
- (K) FULL DEPTH HMA PAVEMENT FOR MAINLINE 165 #/SY QC/QA-HMA, 3, 76, SURFACE 9.5 mm, ON 275 #/SY QC/QA-HMA, 3, 76, INTERMEDIATE 19.0 mm, ON XXX #/SY QC/QA-HMA, 3, 64, BASE 19.0 mm, ON XXX #/SY QC/QA-HMA, 5, 76, INTERMEDIATE, 19.0 mm, ON XXX #/SY QC/QA-HMA, 3, 64, BASE 19.0 mm, ON SUBGRADE TREATMENT TYPE III
- (F) CONCRETE SIDEWALK
- (R) HMA OVERLAY FOR MAINLINE 165 #/SY QC/QA-HMA, 3, 76, SURFACE, 9.5 mm, ON XXX #/SY QC/QA-HMA, 3, 76, INTERMEDIATE 19.0 mm, ON XXX ASPHALT SURFACE MILLING
- (10) SAW CUT, FULL DEPTH
- (13) CONCRETE CURB
- (26) SODDING (NURSERY)
- O.F.Z.= OBSTRUCTION FREE ZONE
- C.Z.= CLEAR ZONE

A&Z ENGINEERING
9017 Coldwater Road, Suite 500
Fort Wayne, IN 46825
260.485.7077
www.az-engineering.net

**PRELIMINARY USE ONLY
NOT FOR CONSTRUCTION**

RECOMMENDED FOR APPROVAL
DESIGN ENGINEER: M.R.S.
CHECKED: W.J.Z. CHECKED: C.H.

**CITY OF FORT WAYNE
MAPLECREST ROAD IMPROVEMENTS**

TYPICAL CROSS SECTIONS

HORIZONTAL SCALE	AS SHOWN
VERTICAL SCALE	N/A
DESIGNATION	1173162
CONTRACT	R35622
SHEETS	5 of 1
PROJECT NUMBER	1173162

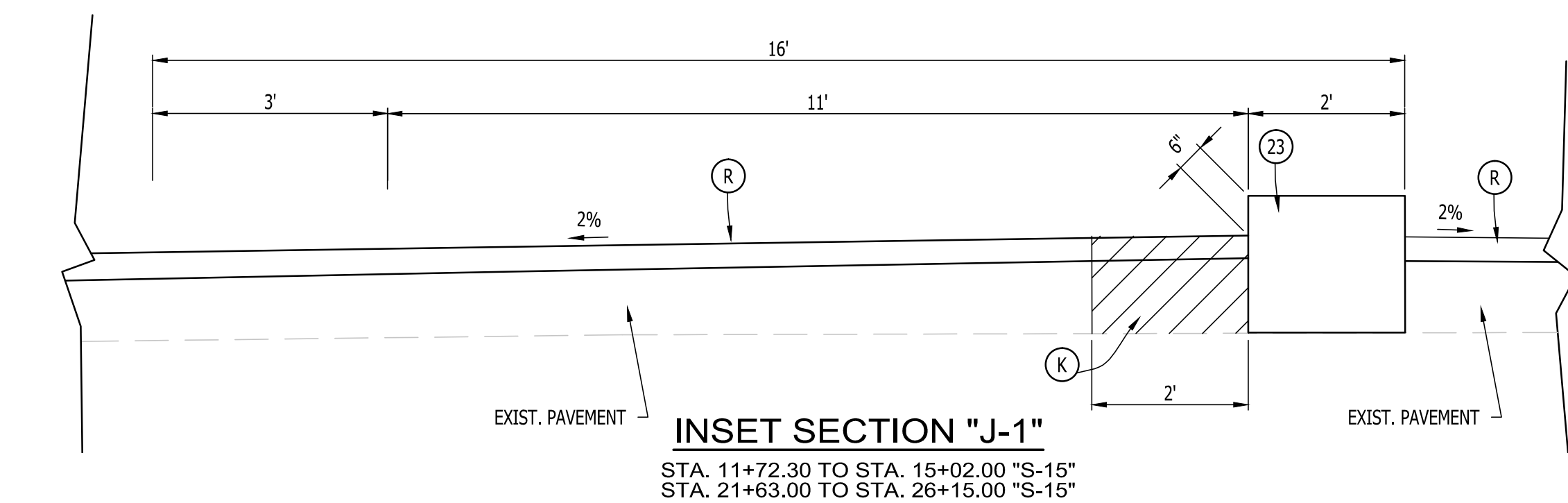
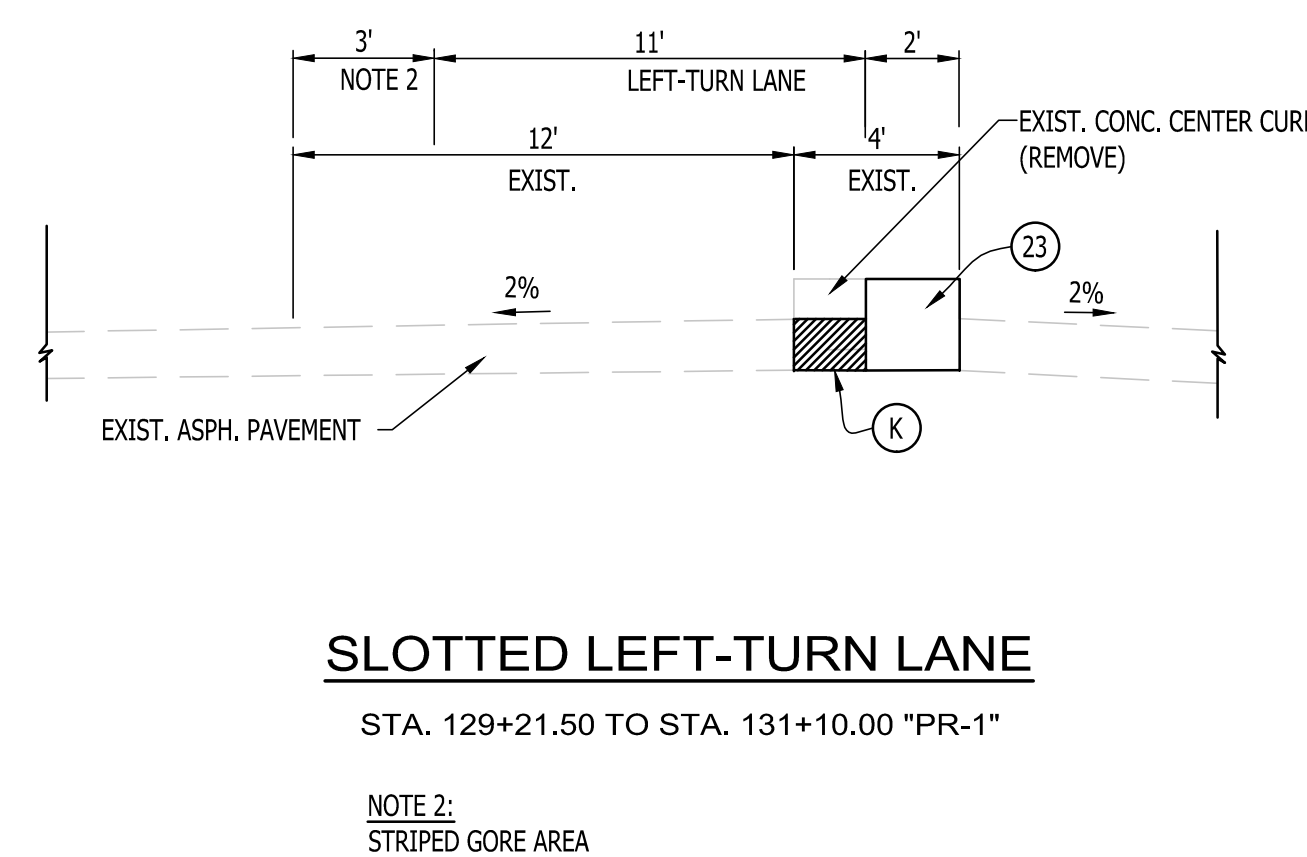
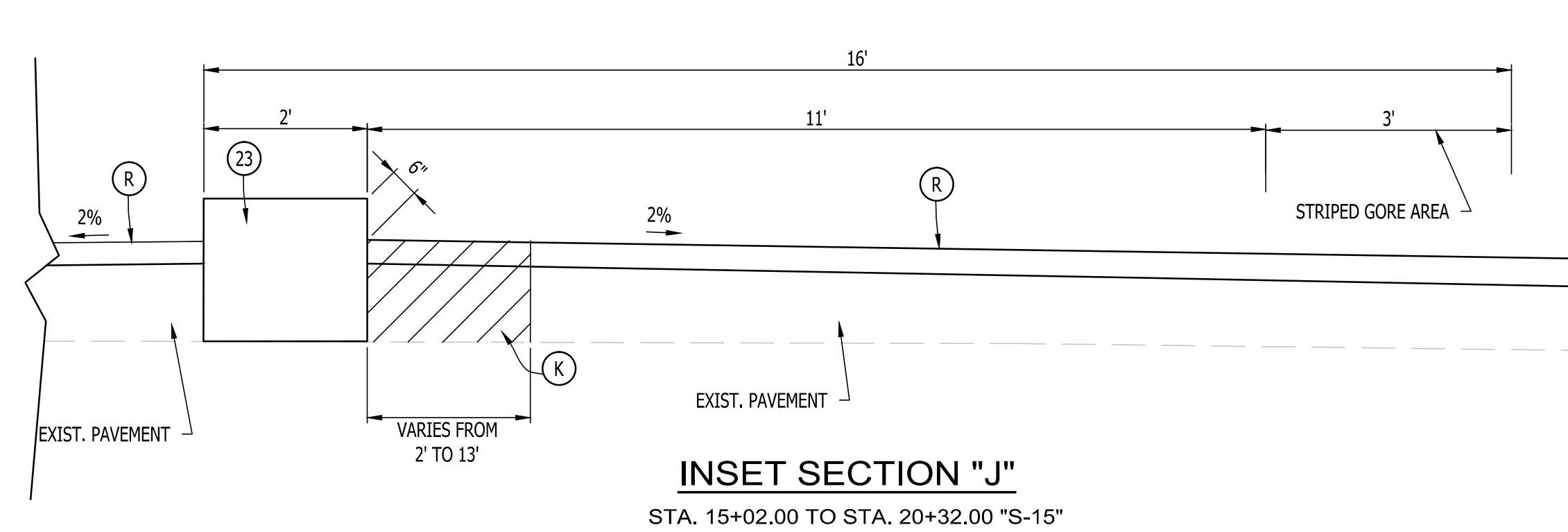
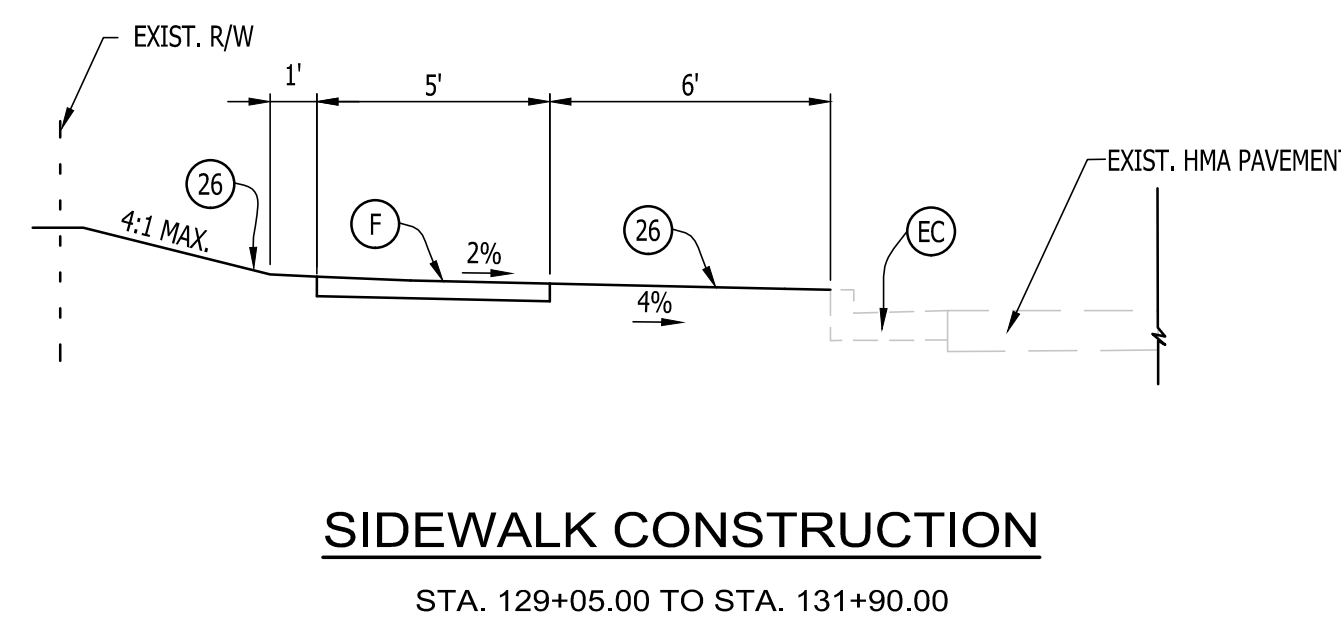
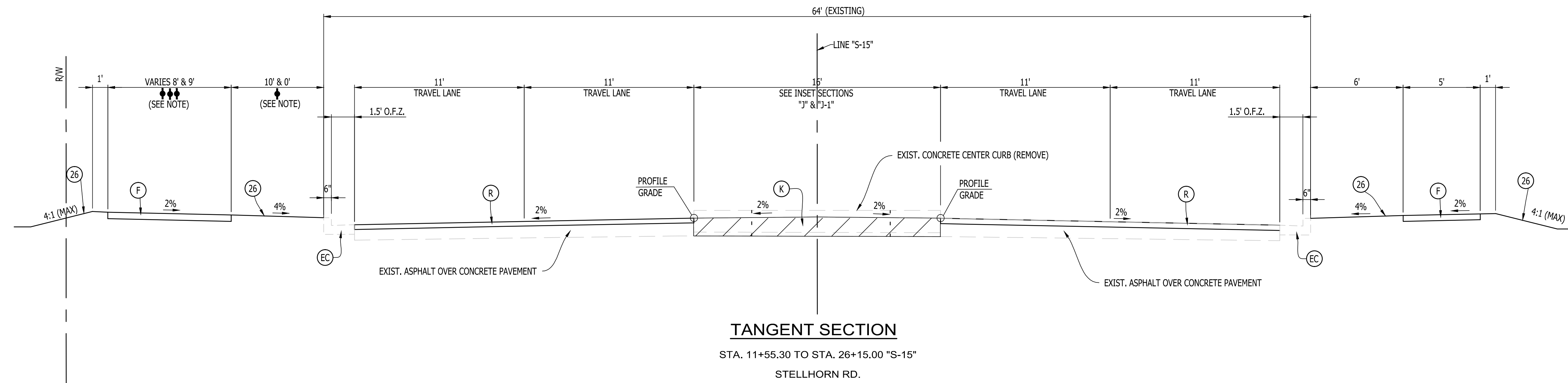

- NOTE:**
- ◆ 0' FROM STA. 18+57.00 TO STA. 19+54.00 "S-15"
 - ◆ VARIES FROM 10' AT STA. 15+88.00 TO 0' AT STA. 17+70.00 "S-15"
 - ◆ 9' FROM 18+57.00 TO STA. 19+45.90 "S-15"

LEGEND

- (F) CONCRETE SIDEWALK
- (EC) EXISTING, CONC. CURB AND GUTTER (TO REMAIN)
- (K) FULL DEPTH HMA PAVEMENT FOR MAINLINE
 165 #/SY QC/QA-HMA, 3, 76, SURFACE 9.5 mm, ON
 275 #/SY QC/QA-HMA, 3, 76, INTERMEDIATE 19.0 mm, ON
 XXX #/SY QC/QA-HMA, 3, 64, BASE 19.0 mm, ON
 XXX #/SY QC/QA-HMA, 5, 76, INTERMEDIATE, 19.0 mm, ON
 XXX #/SY QC/QA-HMA, 3, 64, BASE 19.0 mm, ON
 SUBGRADE TREATMENT TYPE ___
- (R) HMA OVERLAY FOR MAINLINE
 165 #/SY QC/QA-HMA, 3, 76, SURFACE, 9.5 mm, ON
 XXX #/SY QC/QA-HMA, 3, 76, INTERMEDIATE 19.0 mm, ON
 XXX ASPHALT SURFACE MILLING
- (23) CONCRETE CENTER CURB TYPE "D"
- (26) SODDING (NURSERY)

O.F.Z= OBSTRUCTION FREE ZONE

S:\2013 Projects\13-359 Fort Wayne - Maplecrest Road State to Stellhorn\CAD\13-359 TX.dwg ---- 11/10/2015 2:08 PM ---- AZuser

A&Z ENGINEERING
 9017 Coldwater Road, Suite 500
 Fort Wayne, IN 46825
 260.485.7077
 www.az-engineering.net

**PRELIMINARY USE ONLY
 NOT FOR CONSTRUCTION**

RECOMMENDED FOR APPROVAL
 DESIGN ENGINEER: [Signature]
 ASSIGNED: C.H. DRAWN: M.R.S.
 CHECKED: W.J.Z. CHECKED: C.H.

**CITY OF FORT WAYNE
 MAPLECREST ROAD IMPROVEMENTS**

TYPICAL CROSS SECTIONS

HORIZONTAL SCALE	AS SHOWN
VERTICAL SCALE	N/A
DESIGNATION	1173162
CONTRACT	R35622
SHEETS	6 of 6
PROJECT NUMBER	1173162

RIGHT-OF-WAY PLANS

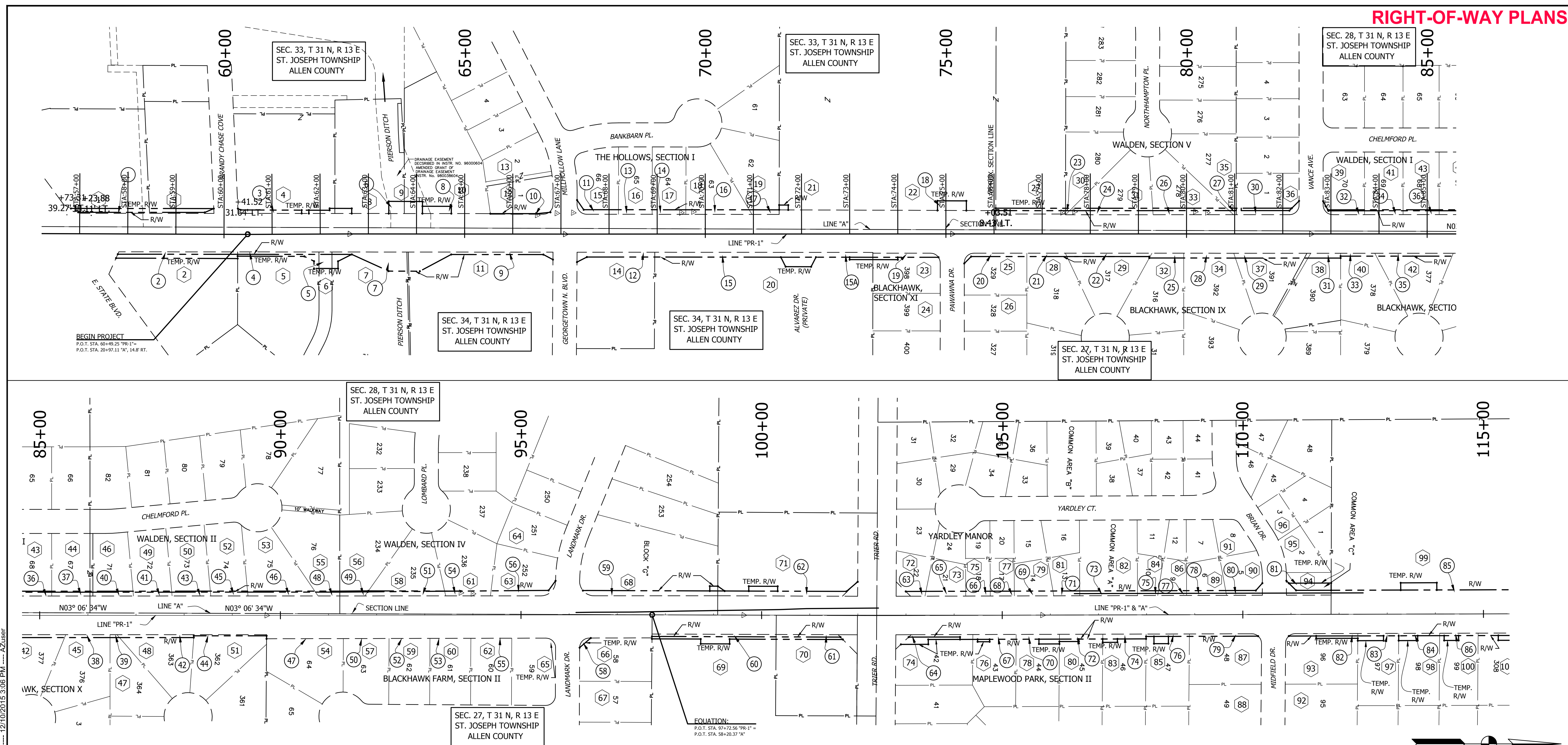

Property Index	Property Owner	Parcel No. (R/W)
1	Hook-Superx, L.L.C.	1
2	Sekhon Enterprises, LLC	2
3	Hook-Superx, L.L.C.	1
4	JGA Property, INC.	3
5	Georgetown/Brown, LLC	4
6	Georgetown North Association	5
7	Conser Holdings, LLC	7
8	LCS Realty, LLC	6
9	Amended Grant of Drainage Easement	-
10	GT Capital, LLC	8
11	Bantry Bay, L.L.C.	9
12	Atiq Saleh	10
13	Alexandros & Stavroula Makridakis	-
14	RRAF, LLC	12
15	Johnny F. III & Kathleen E. Hayes	11
16	Fredric C. Mizner	13
17	Michael E. Yoder	14
18	Marina Kyner	16
19	Thomas J. & Eleanor M. Price	17
20	RLA Blackhawk, LLC	15

Property Index	Property Owner	Parcel No. (R/W)
21	The Sloman Foundation	18
22	The Sloman Foundation	18
23	Erika T. McCuiston	19
24	Linda M. Graber	-
25	Sharon Malone	20
26	Todd R. Jacoby, INC.	-
27	Christ's Church at Georgetown	18
28	Ned D. & Donna M. Calvin	21
29	Jaclyn R. Tracey & Ian R. Wuest	22
30	Nicole M. Achenbach	23
31	Barbara J. Moring	24
32	James A. & Patricia L. Ford	25
33	Nancy McLaughlin	26
34	Steven A. Friend & Kristine L. Smock	28
35	Lawrence D. Watson	27
36	Mary L. Henderson	30
37	Jeffrey E. & Florence J. Marcom	29
38	Allan R. & Patricia A. Bolenbaugh	31
39	Betty Joyce Hille	32
40	Jeffrey A. & Carol C. Lewis	33

Property Index	Property Owner	Parcel No. (R/W)
41	Karla M. Guschling	34
42	Rodney V. & Donna S. England	35
43	Chandra P. Nair & Leela C. Nair	36
44	Yassin G. Habib & Roza K. Hussien	37
45	Jeffrey L. & Kandil K. Harvey	38
46	Juan J. Goodson	40
47	Brianna M. Malakoff-Nwekwo	39
48	Ysidro S. & Christina M. Amaro	42
49	Ross William Parker & Rachel Pohl	41
50	Angela R. Coleman	43
51	Judith Gordon	44
52	Heather Renee & Meredith Allen Yoder	45
53	Nicholas J. & Natasha A. Braun	46
54	Debra L. Morin	47
55	Thomas L. & Carolyn J. Shanfelt	48
56	Steven R. & Anita M. McAfee	49
57	Rick & Theresa Oyler	50
58	Donald E. & Betty J. Dellinger	51
59	Justin M. Halter	52
60	Filemon Alcantar	53

Property Index	Property Owner	Parcel No. (R/W)
61	The Dorothy R. Gatchell Revocable Trust (2007)	54
62	James W. & Sandra A. Kiraly	55
63	Sean P. & Samathalynn F. Bennett	56
64	Erin E. Bixler	-
65	Juanita G. Farias	-
66	James M. Birkenbeul	58
67	Brandi Scott	-
68	OB Child Care, LLC	59
69	Georgetown Community Little League, INC.	60
70	National City Bank of Indiana (Fort Wayne National Bank)	61
71	QHG of Fort Wayne, INC.	62
72	Didomenico, Robert M. & Jean M.	63
73	Larry H. & Janice L. Wise	65
74	Gary L. Carnahan	64
75	Edward Patire & Kelly Patire	66
76	Patrick J. Madden	67
77	Carol E. Rogers	68
78	Jackie R. & Donna J. Quaintance	70
79	Tammy Sorrels	79
80	Ruben Jimenez Ramirez & Leah R. Jimenez	72

Property Index	Property Owner	Parcel No. (R/W)
81	Marcia J. Cox	71
82	Yardley Manor Homeowners Association	73
83	Adolfo Gartner	74
84	Judy N. Edgar	75
85	William C. Sumerix	76
86	Joseph C. Habegger	77
87	The Davis Family Trust	79
88	Michael S. & Jennifer J. Ruprecht	-
89	Jamie Galbraith	78
90	Ann N. Elliott	80
91	Kristina L. Smith	-
92	Michael C. Vandegrift	-
93	Bondi L. Sholar	82
94	Yardley Manor Homeowners Association	81
95	Michael A. & Cheryl L. Steismeyer	-
96	Michael D. Buchmeier & Brian R. Buchmeier	-
97	William W. Fisher, Jr. & Lois J. Fisher	83
98	David W. & Tina M. Hoelle	84
99	Mark Douglas, INC.	85
100	Dawn Laporte, Hanks Laporte, & Christopher Laporte	86

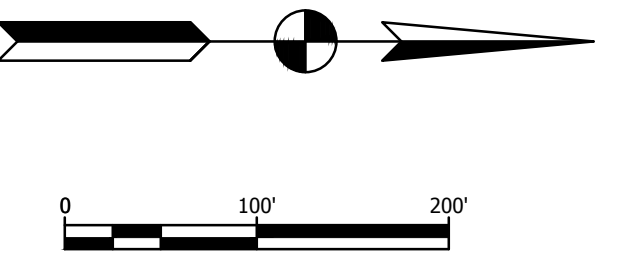

NOTE: ALL RIGHT-OF-WAY DESCRIBED FROM LINE "A"

PROPERTY OWNER INDEX
PARCEL NUMBER

S:\2013 Projects\13-359 Fort Wayne - Maplecrest Road State to Steilhorn\CAD\1 - Maplecrest Road State to Steilhorn.dwg - 12/10/2015 3:06 PM - AZuser

A&Z ENGINEERING
9017 Coldwater Road, Suite 500
Fort Wayne, IN 46825
260.485.7077
www.az-engineering.net

PRELIMINARY USE ONLY
NOT FOR CONSTRUCTION

RECOMMENDED FOR APPROVAL
DESIGN ENGINEER: [Signature]
CHECKED: CH

CITY OF FORT WAYNE
MAPLECREST ROAD IMPROVEMENTS

PLAT NO. 1

HORIZONTAL SCALE	1" = 100'
VERTICAL SCALE	N/A
DESIGNATION	1173162
CONTRACT	R35622
SHEETS	7 of
PROJECT NUMBER	1173162

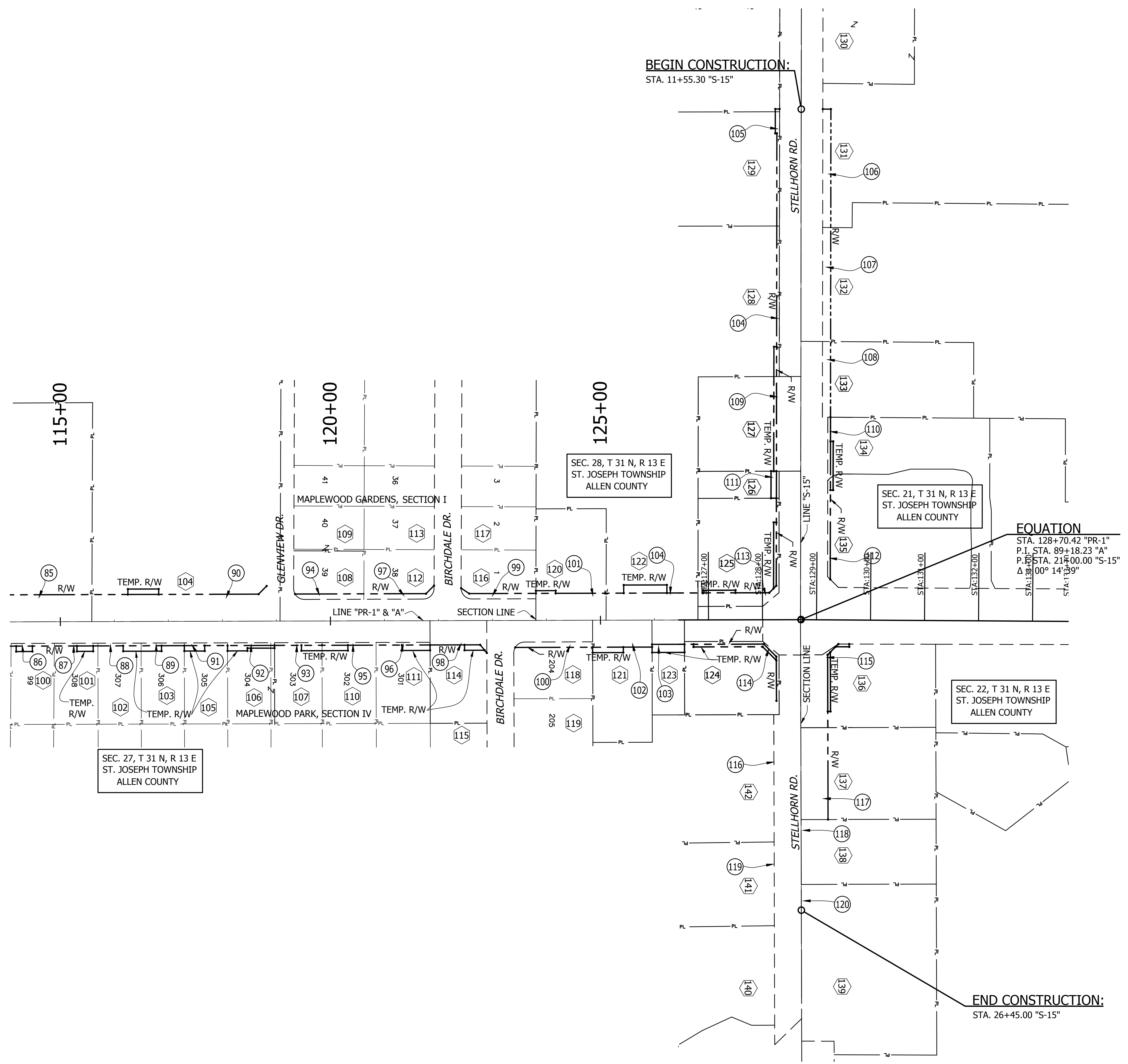

Property Index	Property Owner	Parcel No. (R/W)
101	James E. & Tammy Apollo	87
102	Faustino C. Alcantar	88
103	Thomas F. & Annette E. Jones	89
104	Maplewood Mennonite Church	90
105	Richard S. & Dorothy M. Vanauken	91
106	Kathy L. Martin	92
107	Samual L. McCloskey & Madison R. Valiton	93
108	Marina C. Lenzer	94
109	Dustin M. & Charlene Armstrong	-
110	Lrena L. Walker	95
111	Jason Metzger	96
112	Issaka Selch Djibril	97
113	Joan M. White	-
114	Randy & Meghan Smith	98
115	Mark A. & Jennifer L. Neff	-
116	Janie E. McGill	99
117	Alice R. Reinhard	-
118	Jeana Ellie	100
119	Dale T. & Sue Jennings	-
120	Ramcar, INC.	101
121	Prevall Property, LLC	102
122	Maplewood Plaza, LLC	104
123	Only The Beginning, LLP	103
124	Tellman Real Estate INC	114
125	Ricker Oil Company INC	113
126	Chanchai Sutaphong	111
127	Tri-State Property Management, INC	109
128	Maplewood Plaza, LLC	104
129	Lennington Stellhorn Realty, LLC	105
130	Freeland Realty, LLC	-
131	Simon Property Group LP	106
132	Target Corporation	107
133	Indyfort, LLC (McDonalds)	108
134	Associates, Inc.	110
135	John M. Reid, Trustee of the Reid Trust	112
136	BKD Maplecrest Stellhorn, LLC	115
137	Genadi Zatzhni	117
138	John W. Hayes, III, Revocable Living Trust and Joyce Gates Hayes Revocable Living Trust	118
139	Mackids, INC.	120
140	Professional Federal Credit Union	-
141	KT Associates XIII, LLC	119
142	Casa Properties, LLC	116

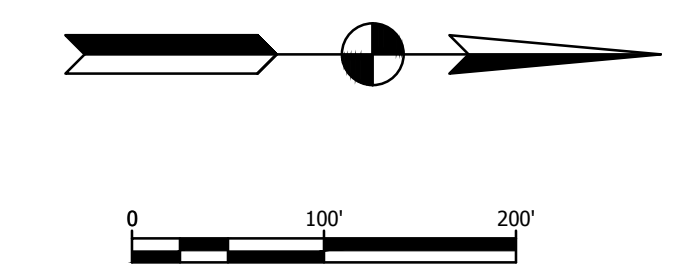

NOTE: ALL RIGHT-OF-WAY DESCRIBED FROM LINE "A" & "S-15"

- # PROPERTY OWNER
- # PARCEL NUMBER

S:\2013 Projects\13-359 Fort Wayne - Maplecrest Road State to Stellhorn\CAD\F1 Stellhorn.dwg ---- 12/10/2015 2:52 PM ---- AZuser

A&Z ENGINEERING
 9017 Coldwater Road, Suite 500
 Fort Wayne, IN 46825
 260.485.7077
 www.az-engineering.net

PRELIMINARY USE ONLY
NOT FOR CONSTRUCTION

RECOMMENDED FOR APPROVAL
 DESIGN ENGINEER: [Signature] DATE: []/[]/[]
 CHECKED: CH CHECKED: CH

**CITY OF FORT WAYNE
 MAPLECREST ROAD IMPROVEMENTS**

PLAT NO. 1

HORIZONTAL SCALE	1" = 100'
VERTICAL SCALE	N/A
DESIGNATION	1173162
CONTRACT	R35622
SHEETS	8 of []
PROJECT NUMBER	1173162